

List of tables

- Table 1** - Crankcase
- Table 2** - Oil sump
- Table 3** - Crankshaft and Starter
- Table 4** - Connecting rods
- Table 5** - Cylinder heads
- Table 6** - Carburettor
- Table 7** - Air inlet and manifolds
- Table 8** - Feeding and controls
- Table 9** - Exhaust manifolds, silencers and extensions
- Table 10** - Timing
- Table 11** - Oil pump and filters
- Table 12** - Water pump and fan
- Table 13** - Distributors and controls
- Table 14** - Wiring - Ignition coils and battery
- Table 15** - Generator and engine breathers
- Table 16** - Clutch
- Table 17** - Clutch housing and gear box
- Table 18** - Intermediate gear box housing
- Table 19** - Gearshift lever
- Table 20** - Countershaft
- Table 21** - Output shaft
- Table 22** - Overdrive and gearbox clamping
- Table 23** - Transmission shaft
- Table 24** - Differential case
- Table 25** - Rear axle
- Table 26** - Rear suspension
- Table 27** - Frame
- Table 28** - Front wheel suspension upper arms
- Table 29** - Front wheel suspension bottom arms
- Table 30** - Pedal board
- Table 31** - Brake control
- Table 32** - Double brake master cylinder
- Table 33** - Front brakes and hubs
- Table 34** - Rear brakes and handbrake
- Table 35** - Tyres - Wheels - Hubs - Axle shafts
- Table 36** - Steering box
- Table 37** - Steering wheel and steering shaft
- Table 38** - Steering linkage
- Table 39** - Water radiator
- Table 40** - Fuel tank
- Table 41** - Toolkit

TAV. 1 - BASAMENTO MOTORE

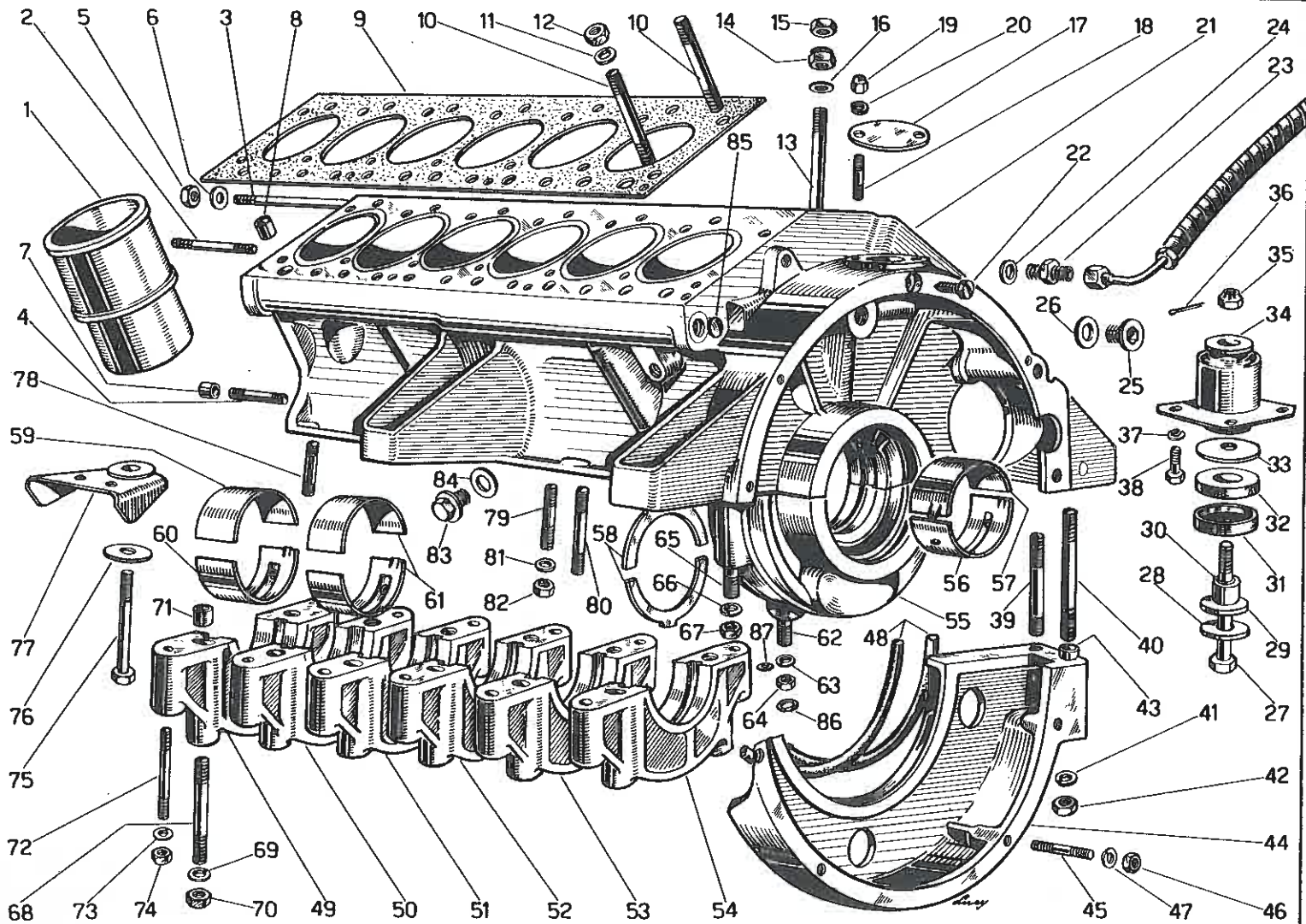

TAV. 2 - COPPA OLIO

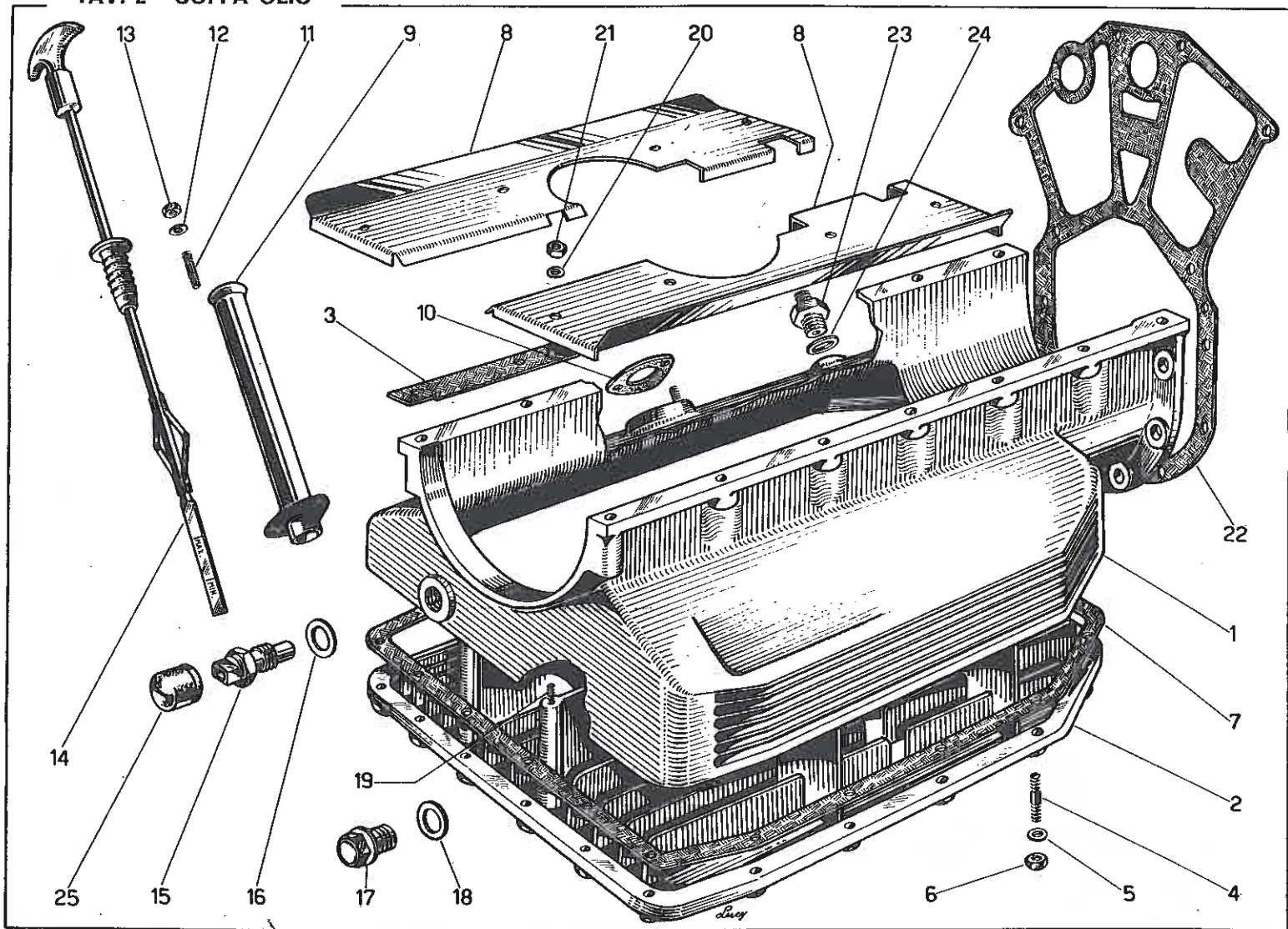

TAV. 3 - ALBERO MOTORE E MOTORINO AVVIAMENTO

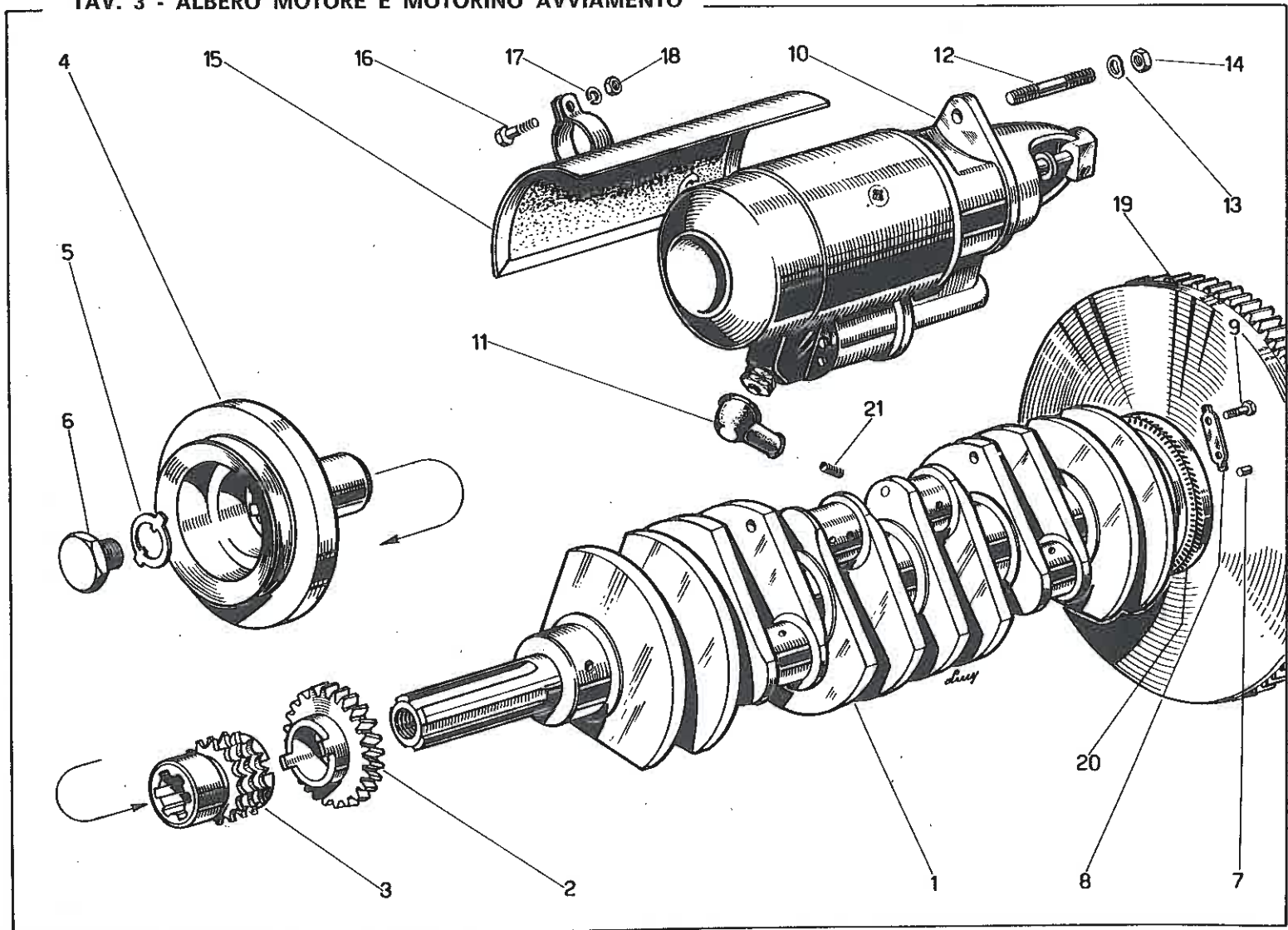

TAV. 4 - BIELLE E PISTONI

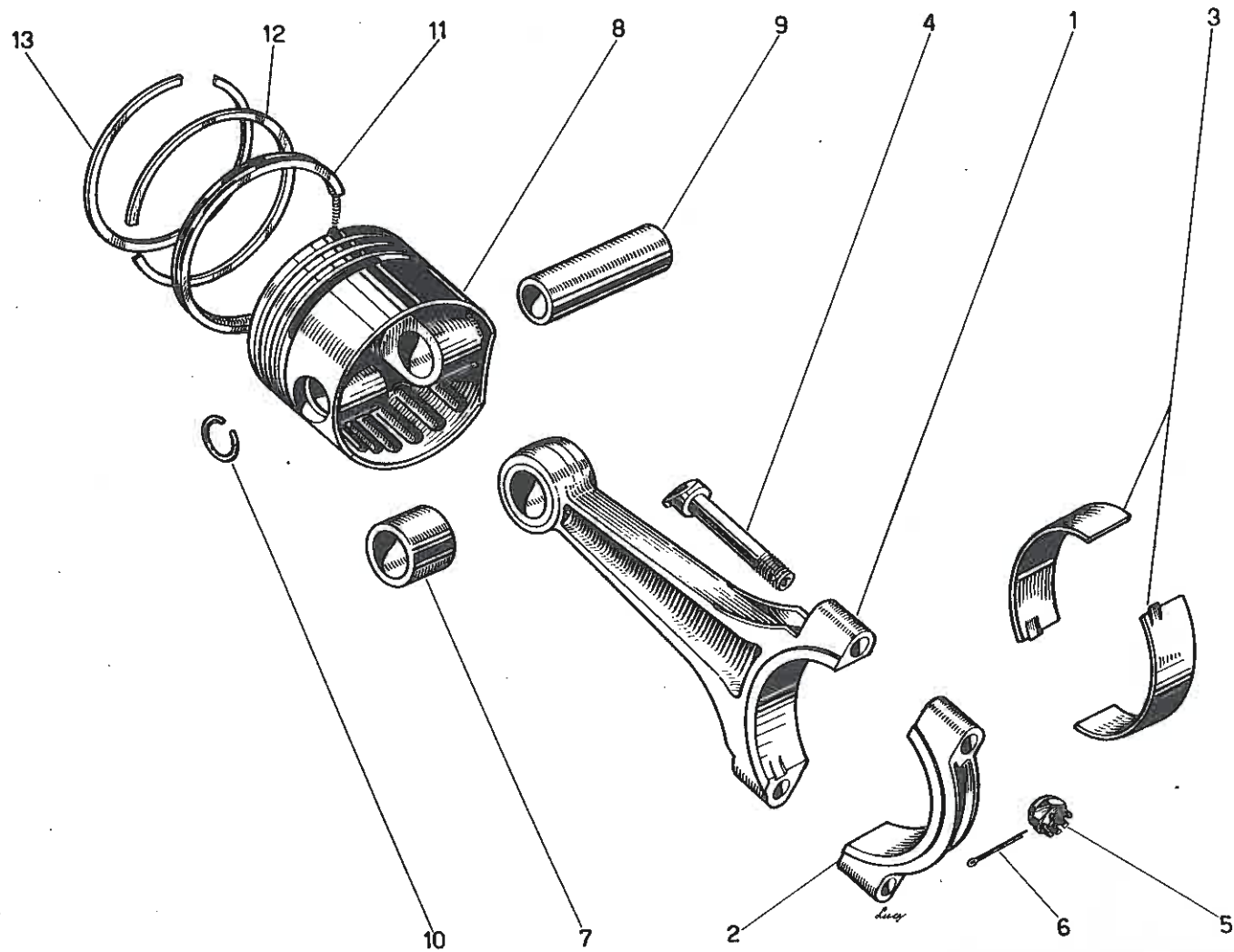

TAV. 5 - TESTE CILINDRI

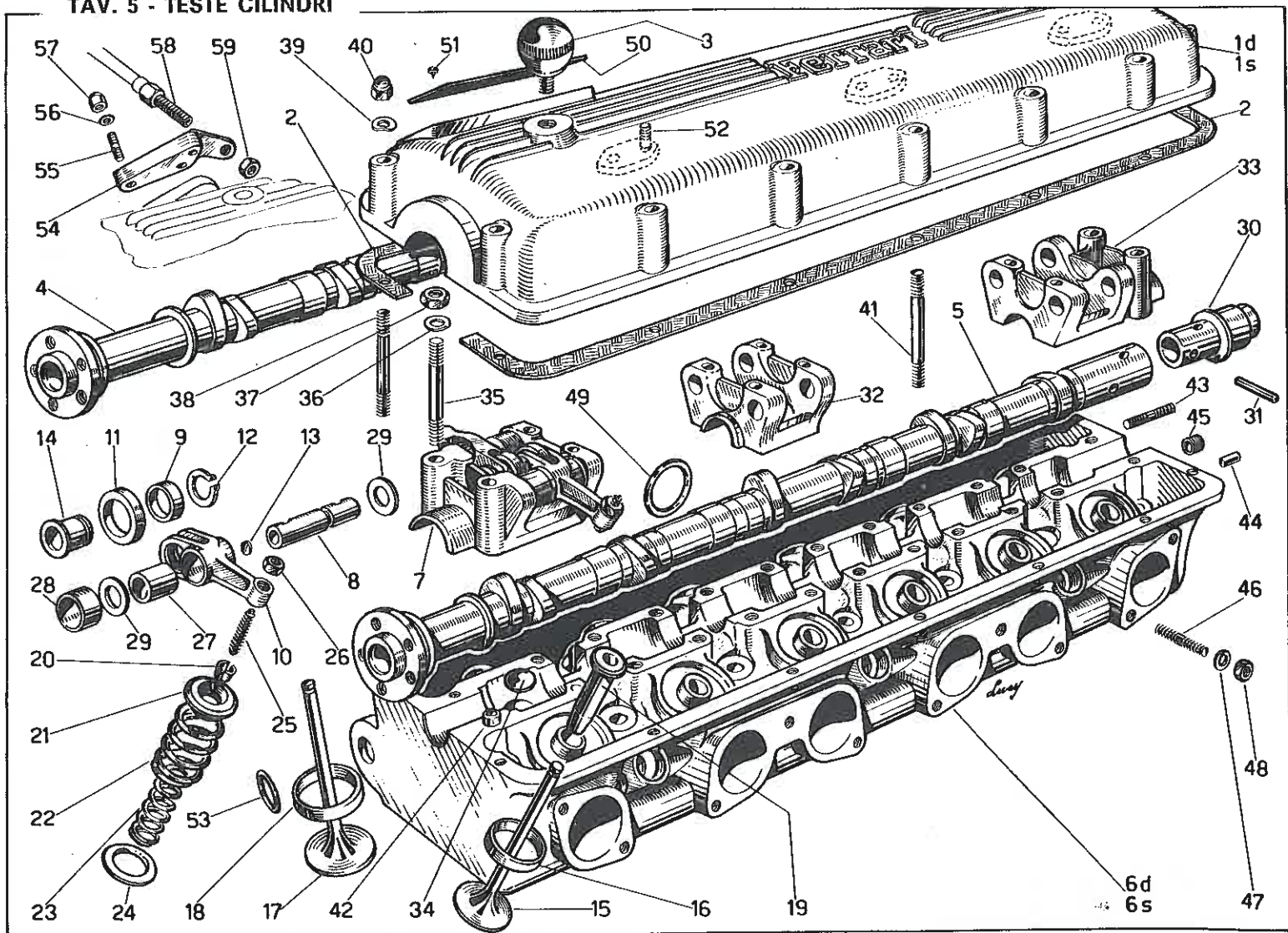

TAV. 6 - CARBURATORE WEBER 40-DCZ/6

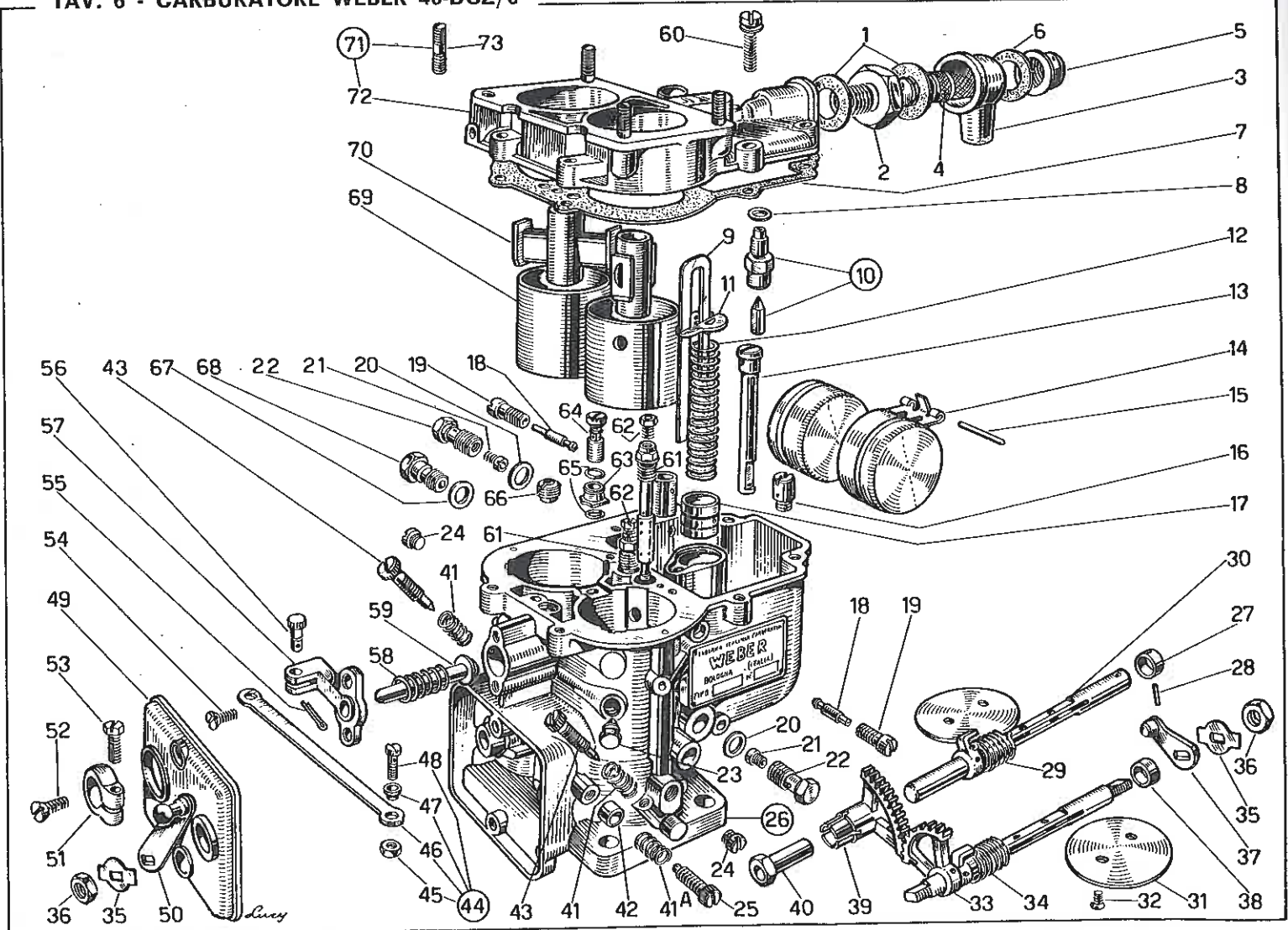

TAV. 7 - PRESA ARIA E COLLETTORI

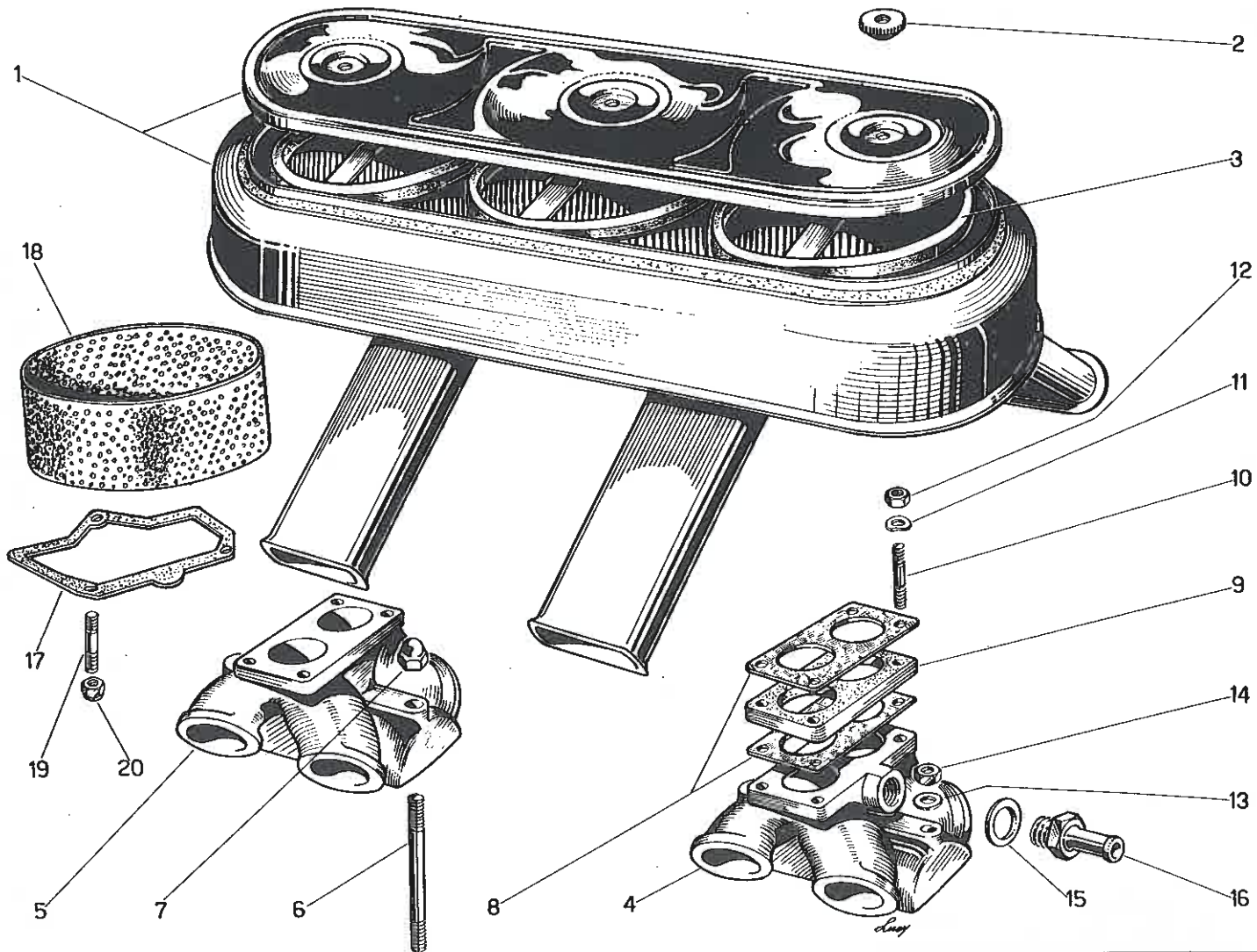

TAV. 8 - ALIMENTAZIONE E COMANDI

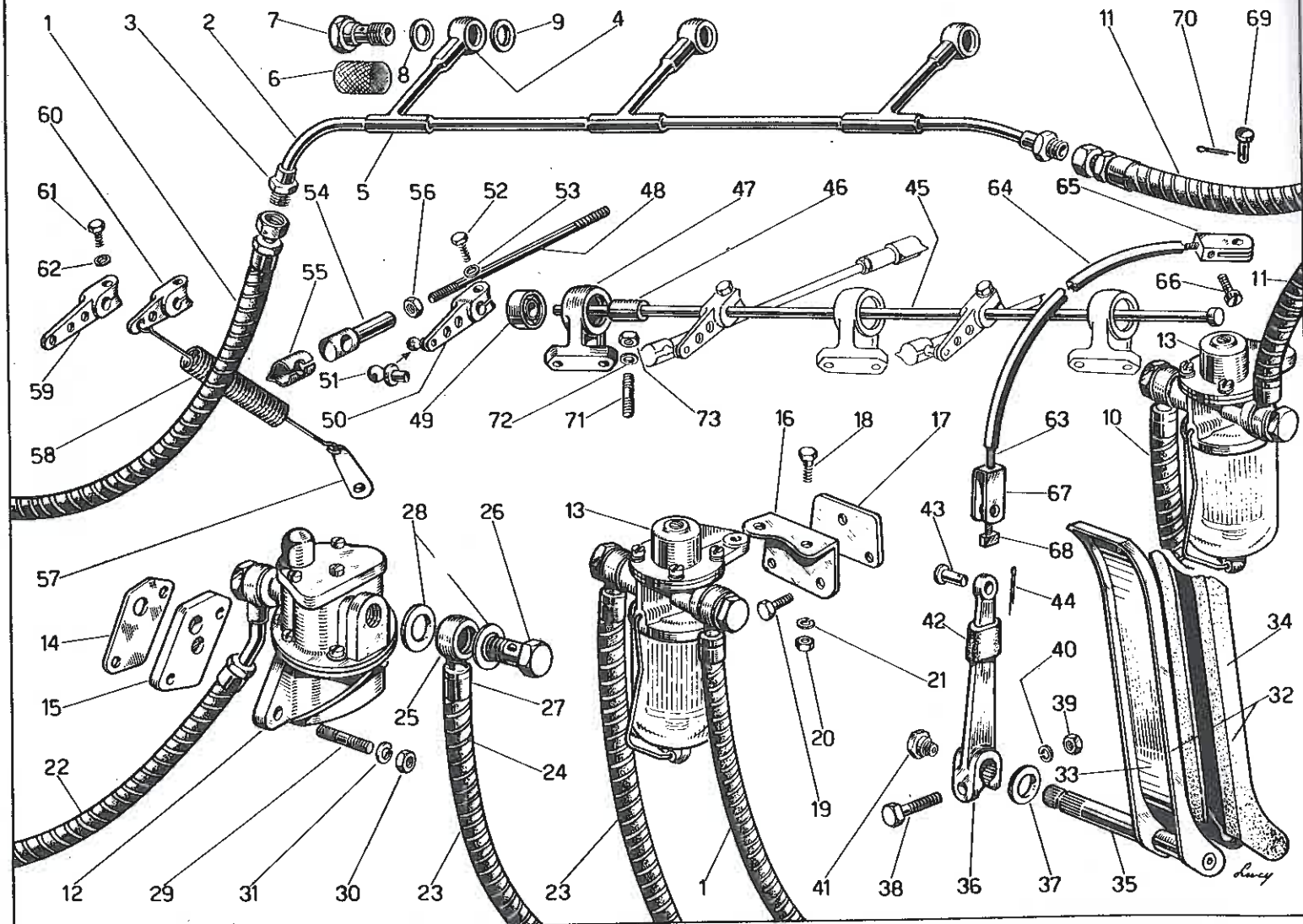

TAV. 9 - COLLETTORI SCARICO - SILENZIATORI E PROLUNGHE

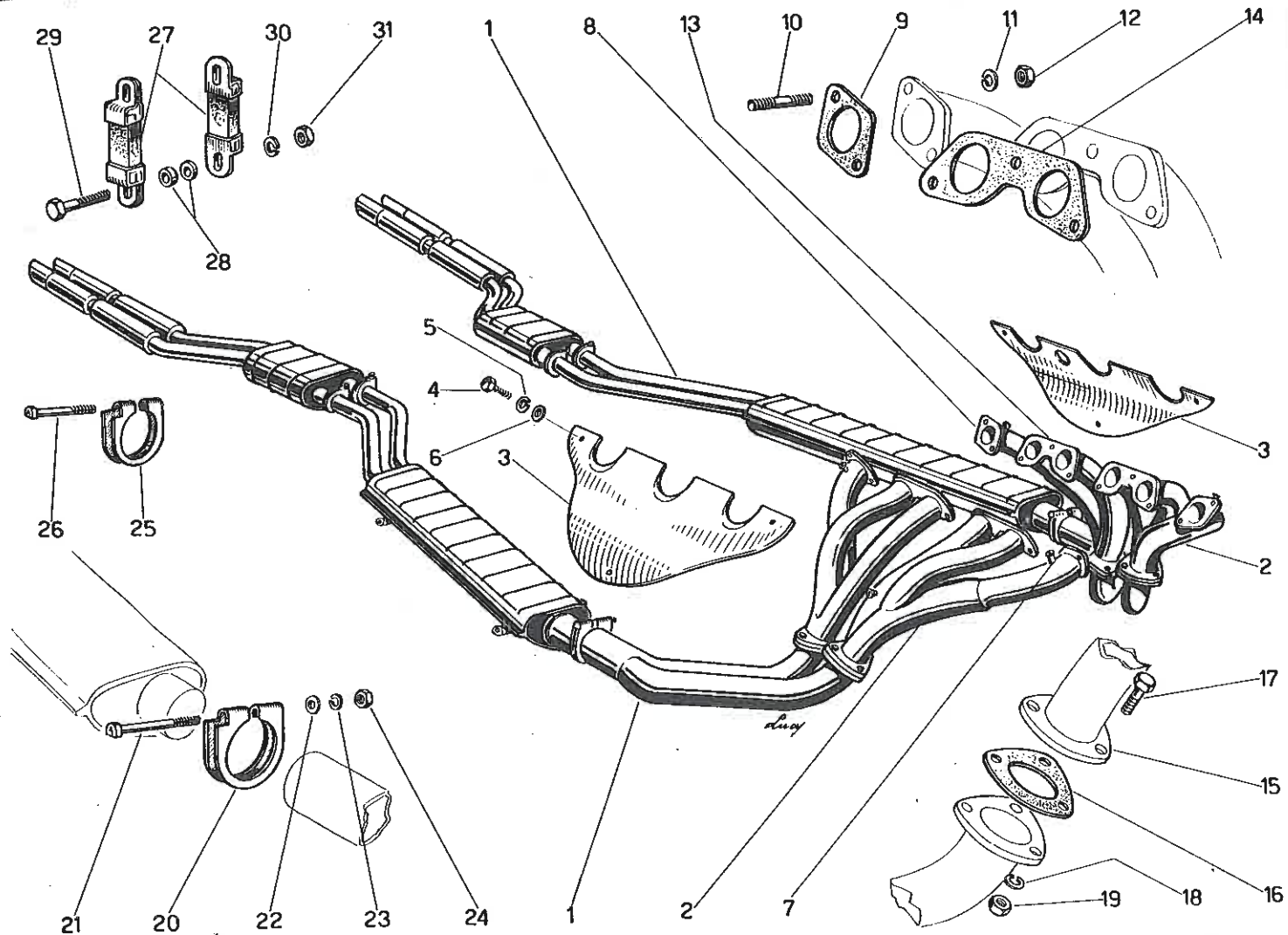

TAV. 10 - DISTRIBUZIONE

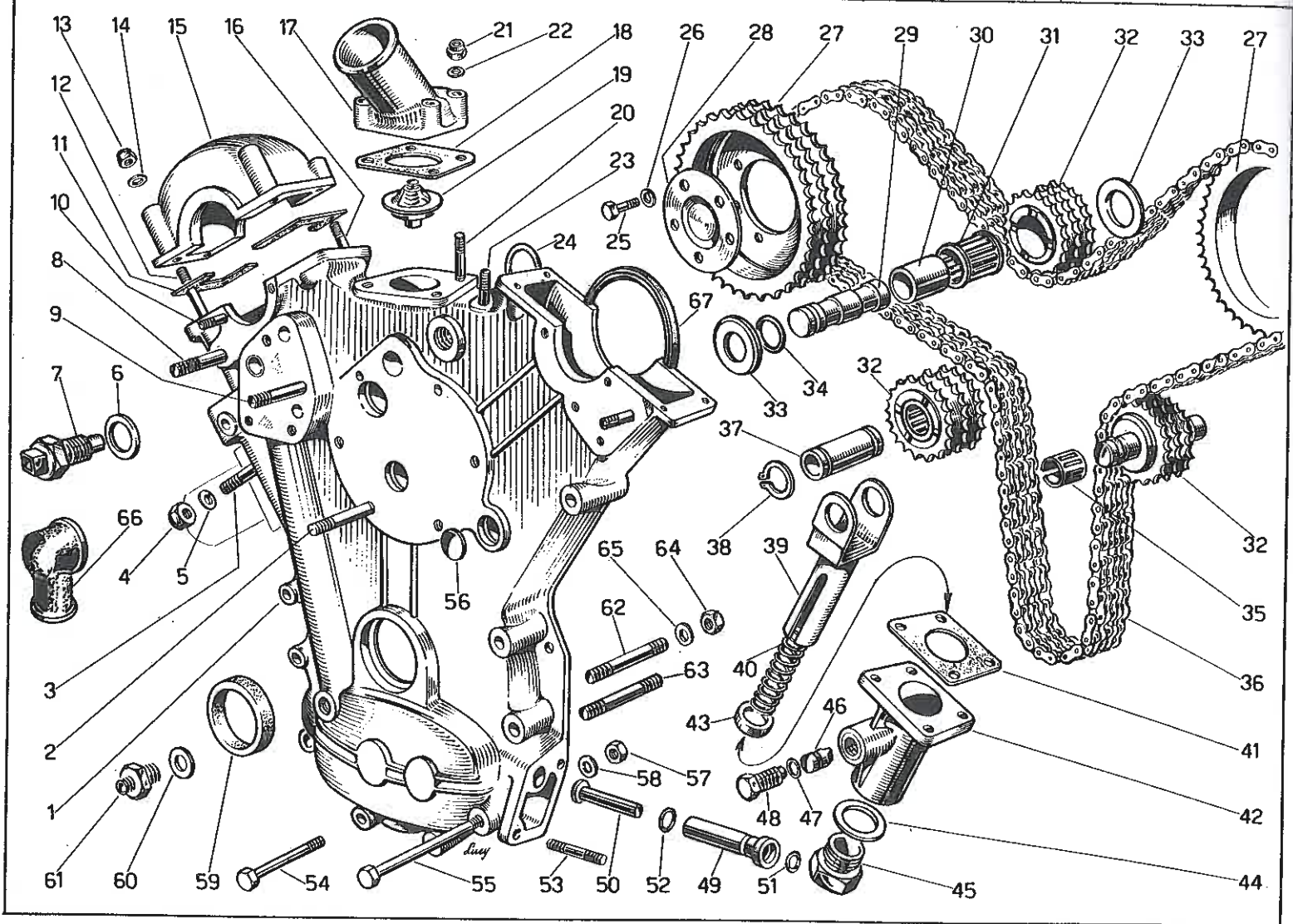

TAV. 11 - POMPA OLIO E FILTRI

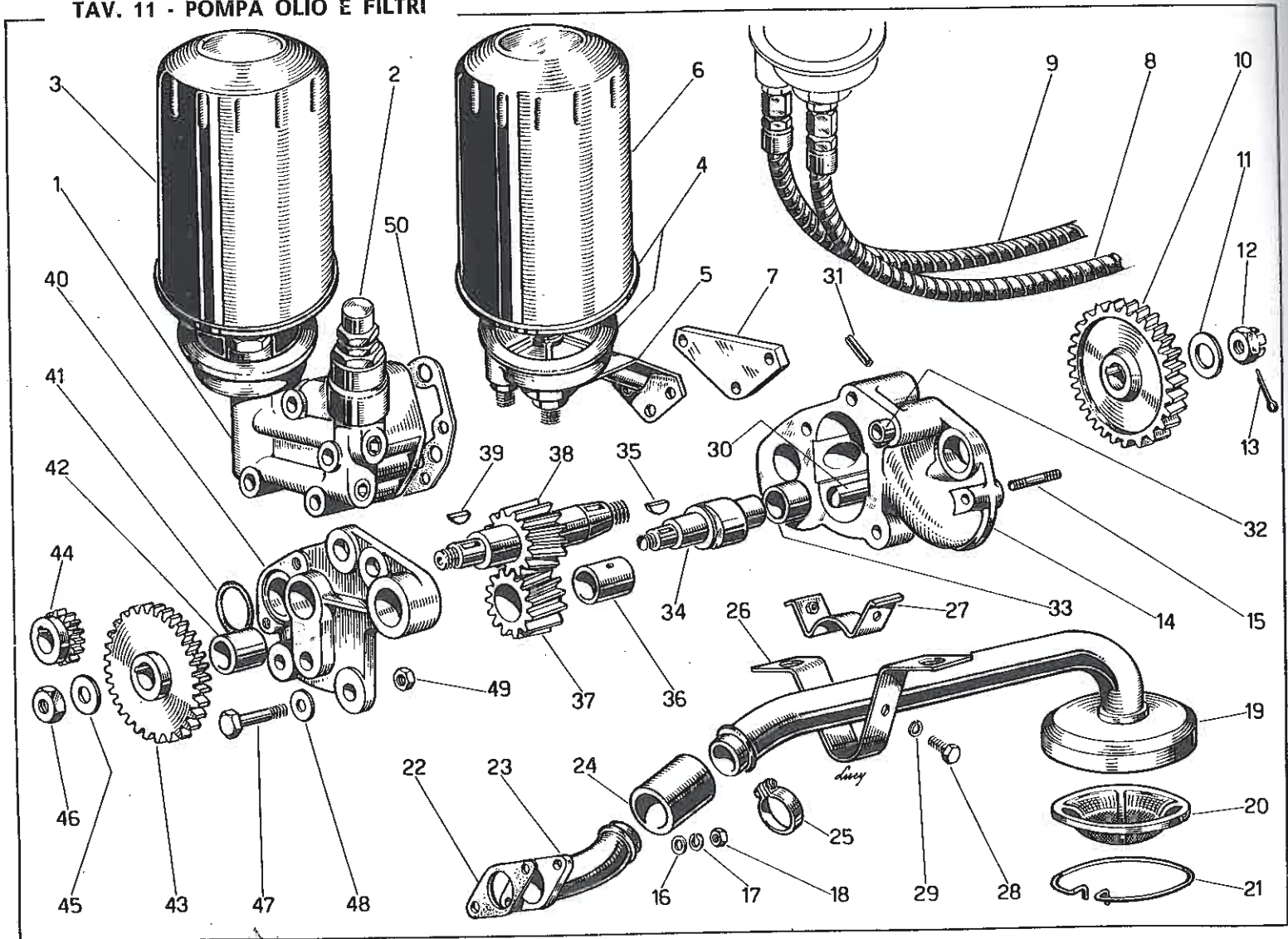

TAV. 12 - POMPA ACQUA E VENTILATORE

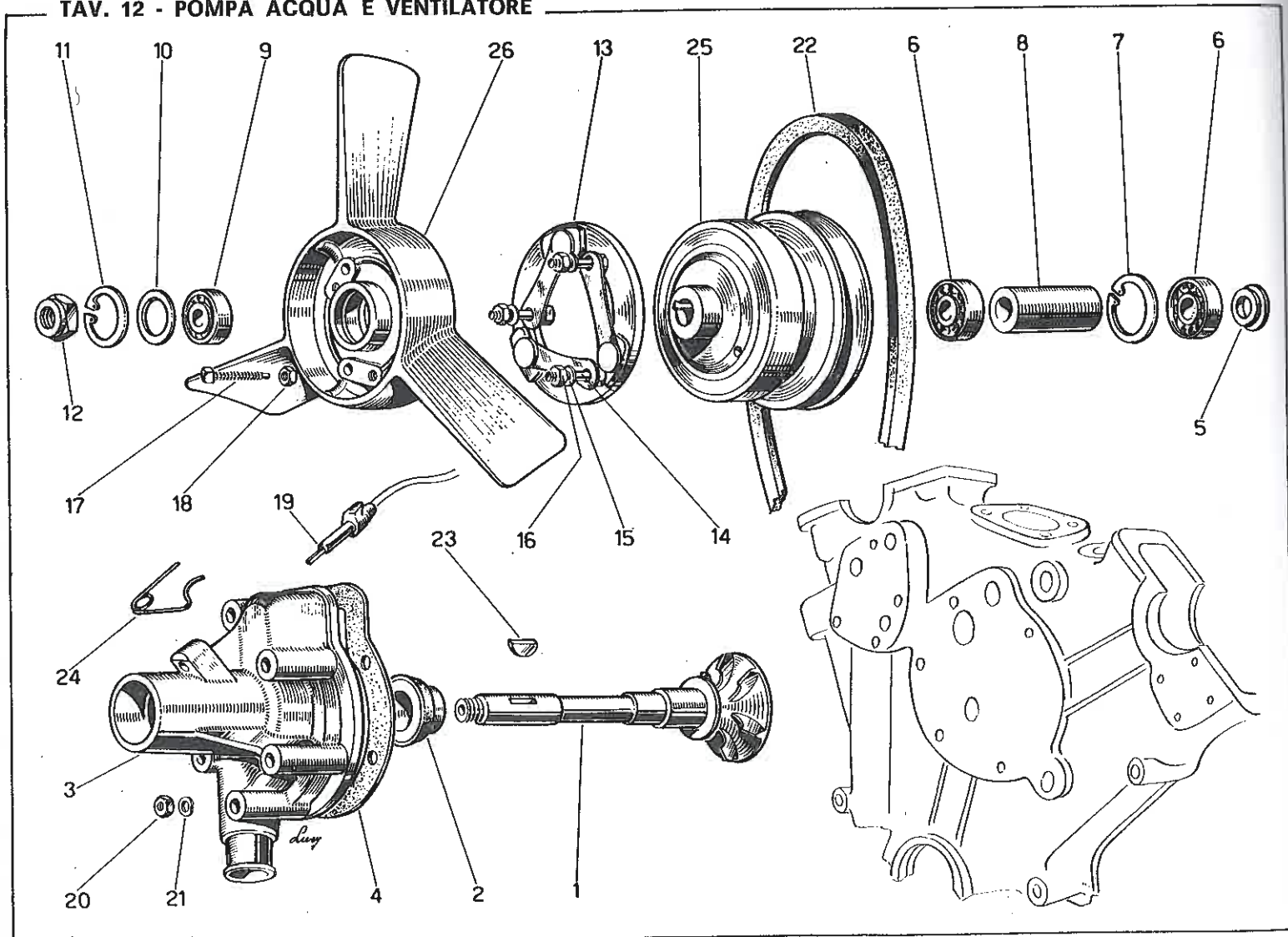

TAV. 13 - SPINTEROGENI E COMANDI

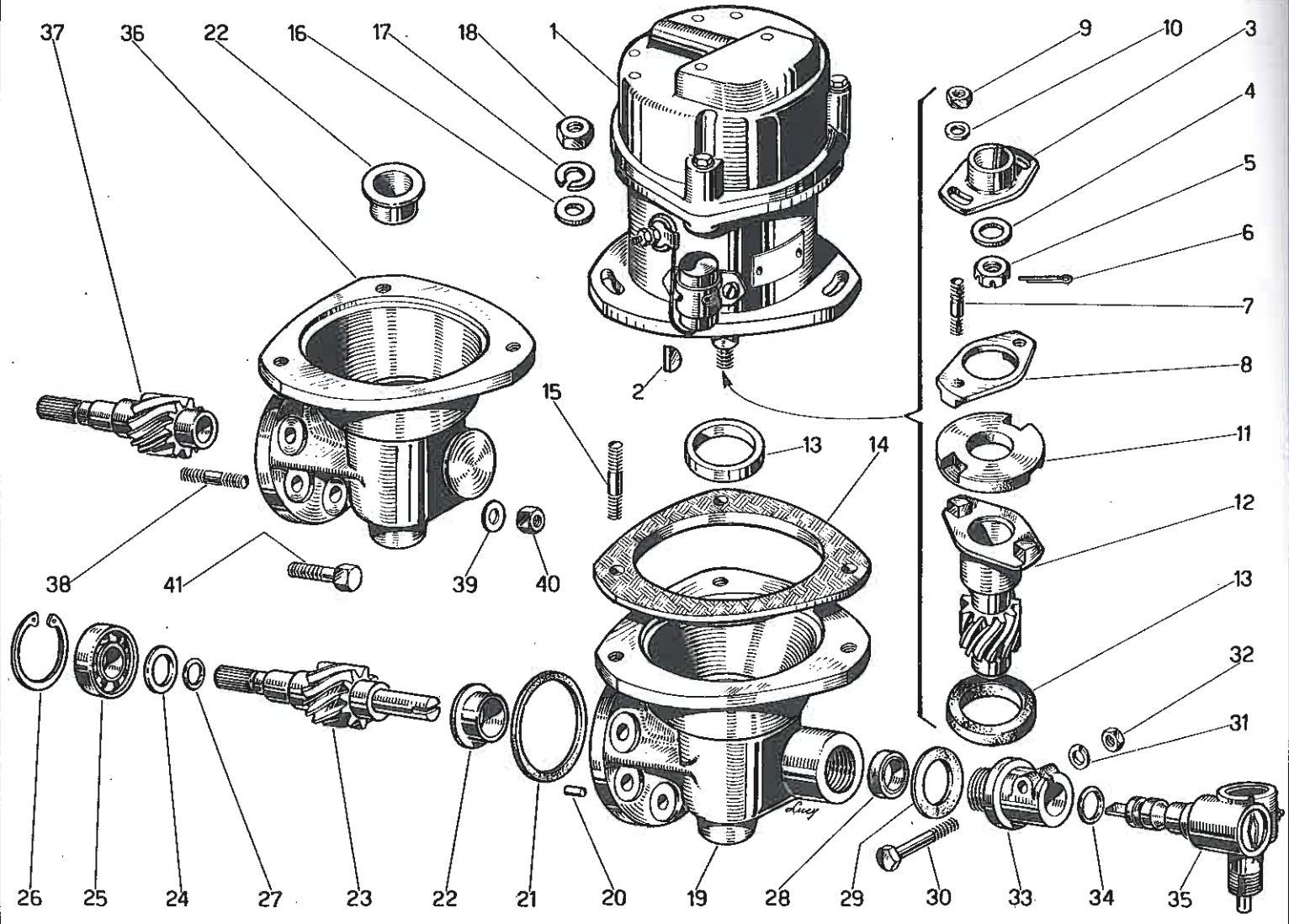

TAV. 14 - FILI - BOBINE E BATTERIA

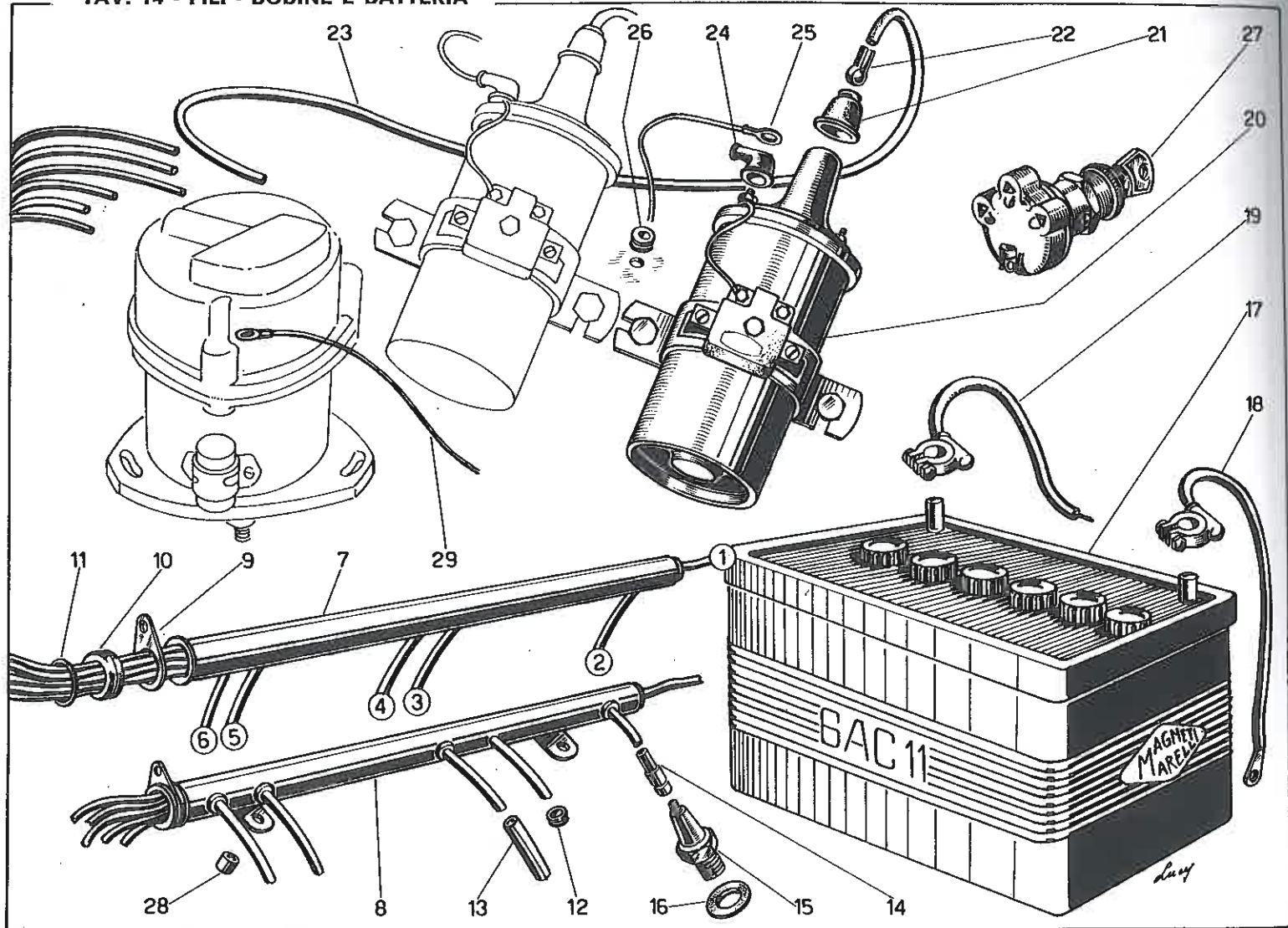

TAV. 15 - GENERATORE E SFIATI MOTORE

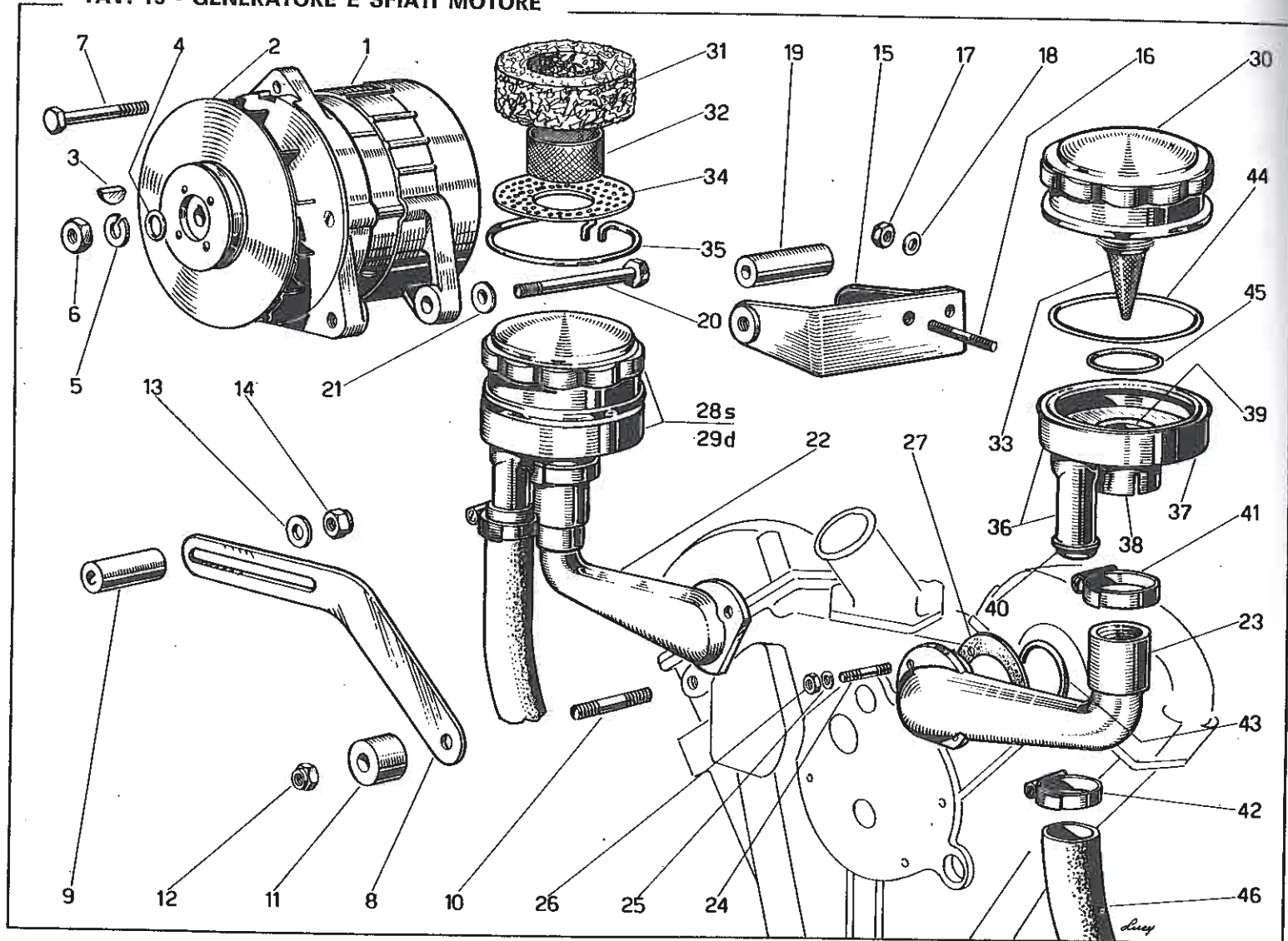

TAV. 16 - FRIZIONE

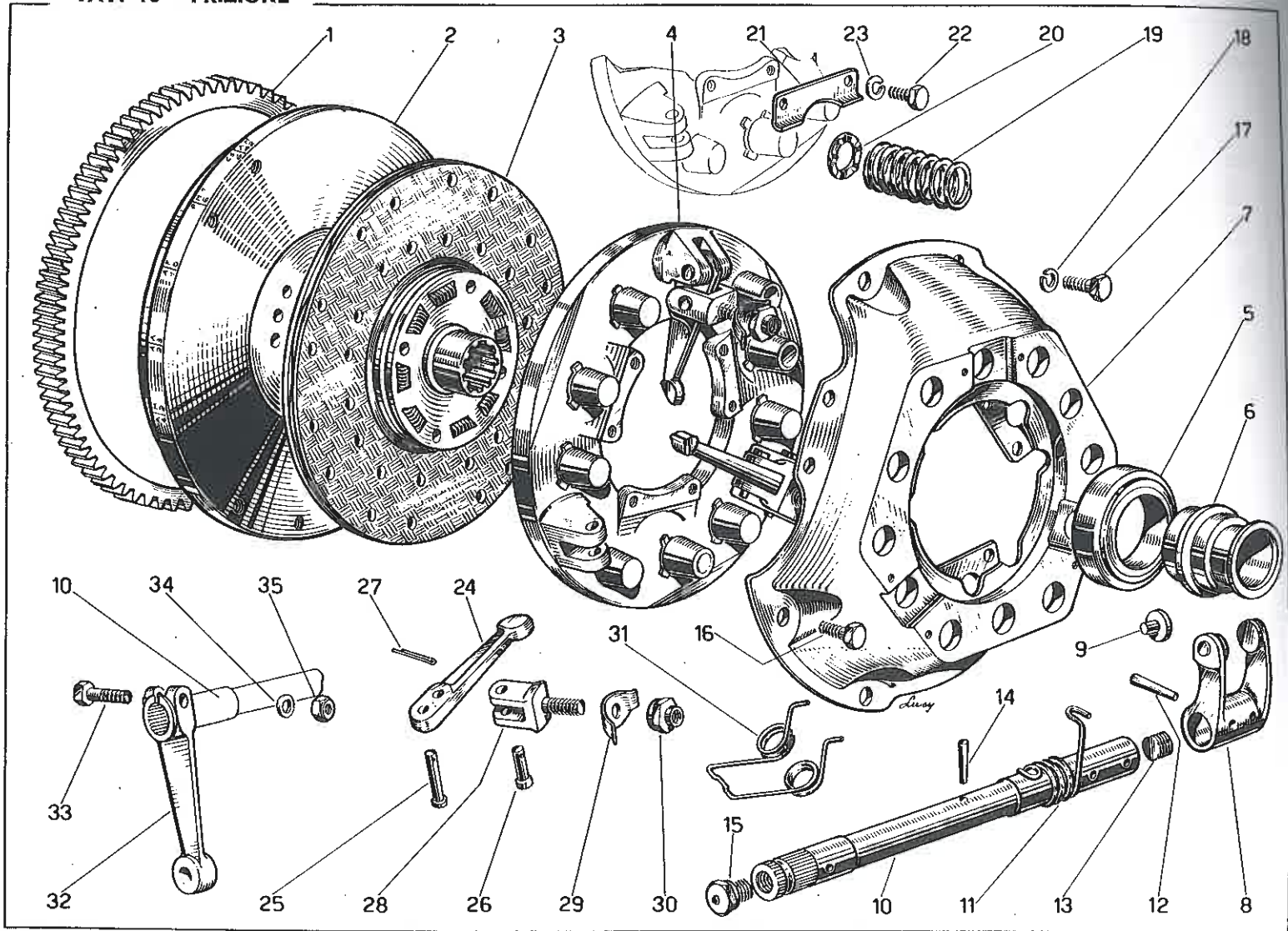

TAV. 17 - CAMPANA FRIZIONE E SCATOLA CAMBIO

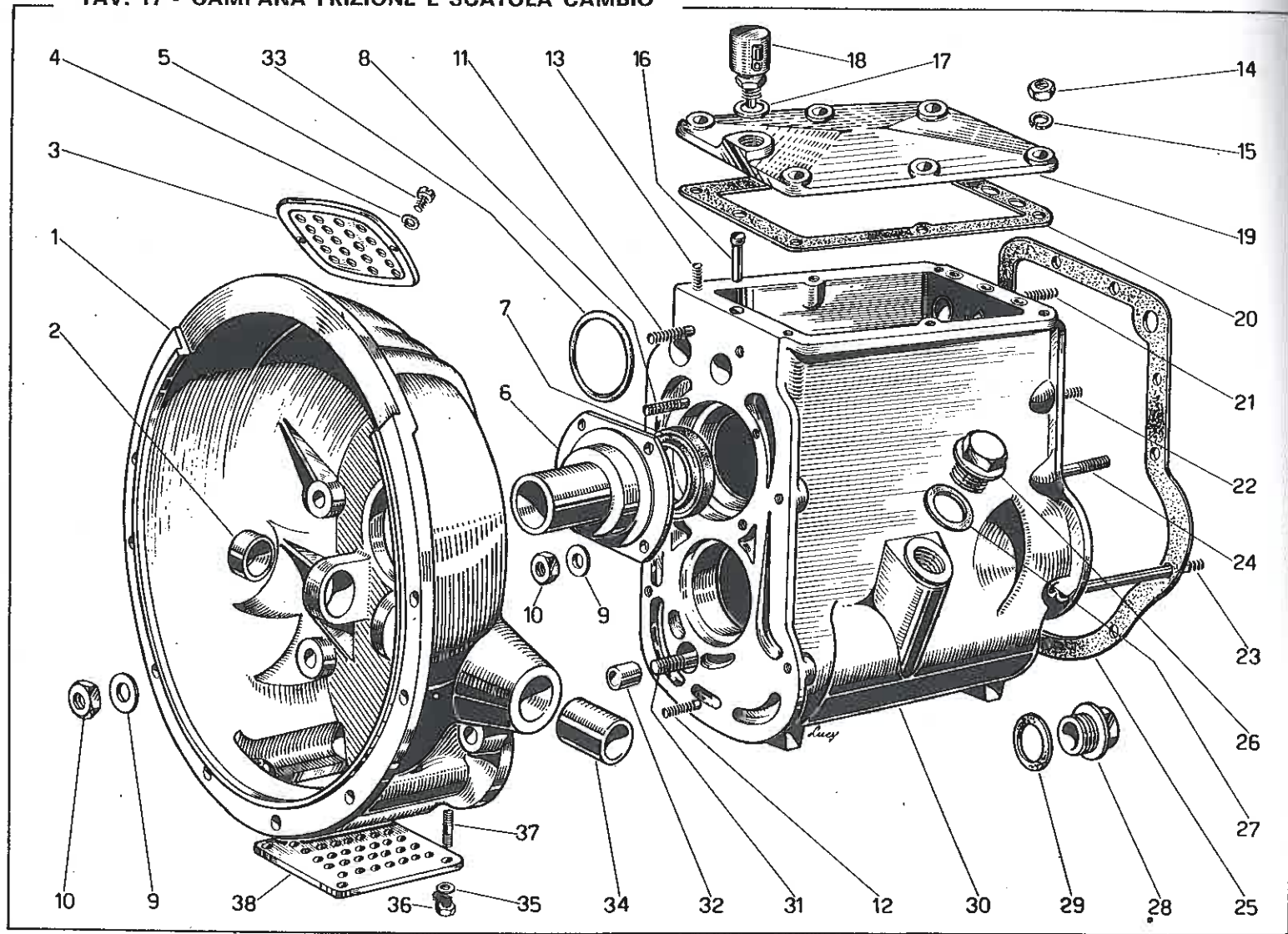

TAV. 18 - CORPO INTERMEDIO CAMBIO

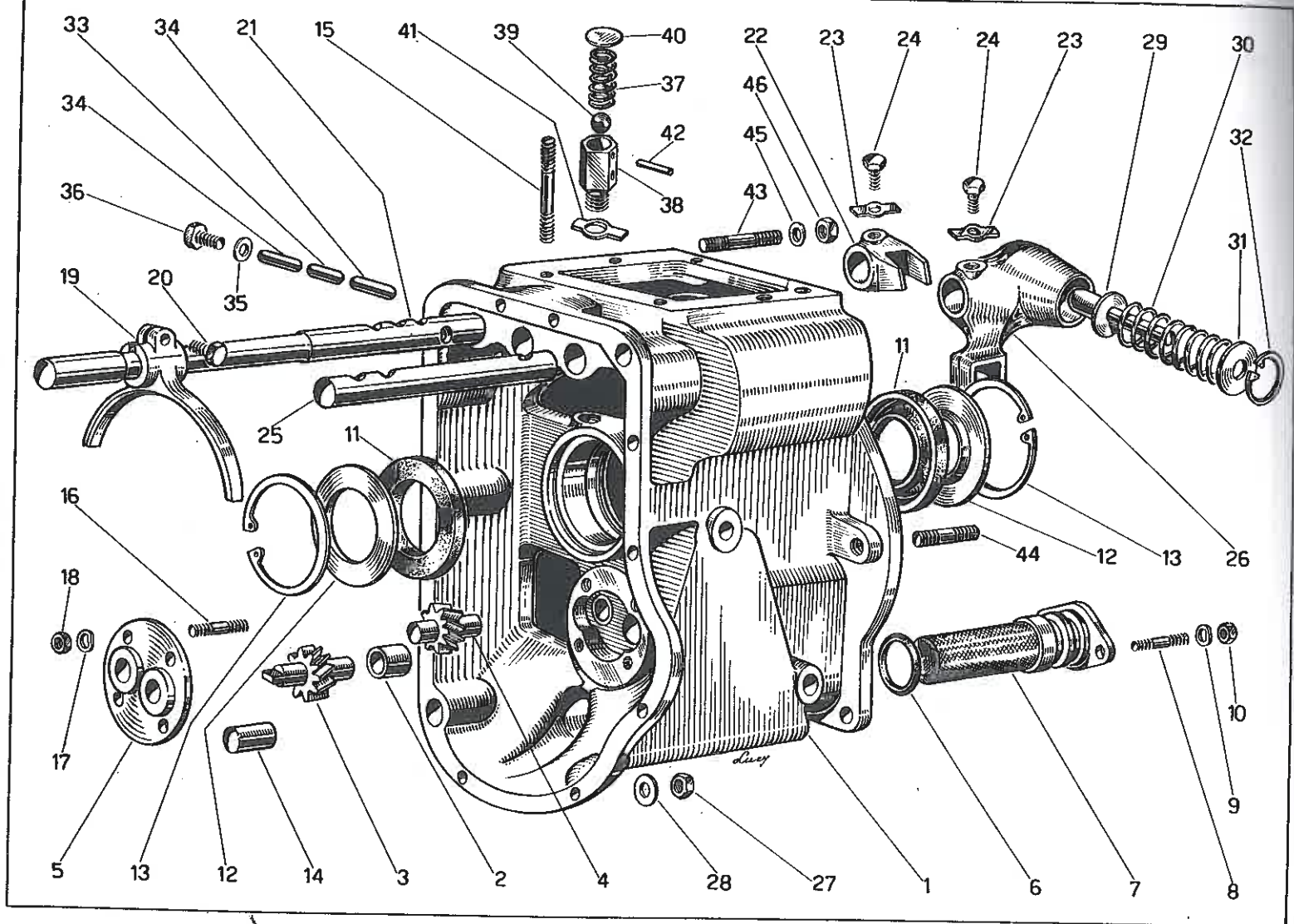

TAV. 19 - LEVA COMANDO CAMBIO

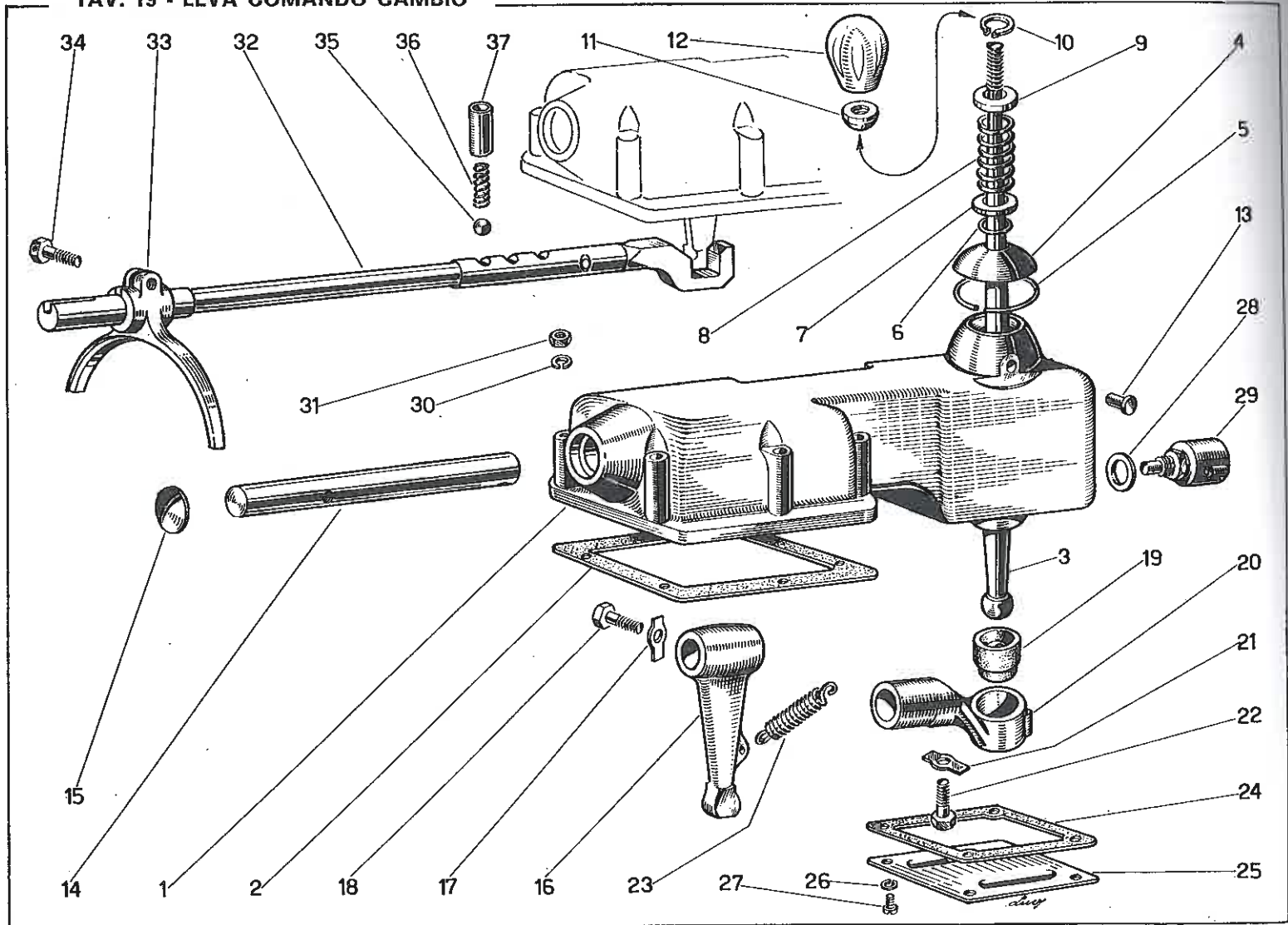

TAV. 20 - ALBERO SECONDARIO CAMBIO

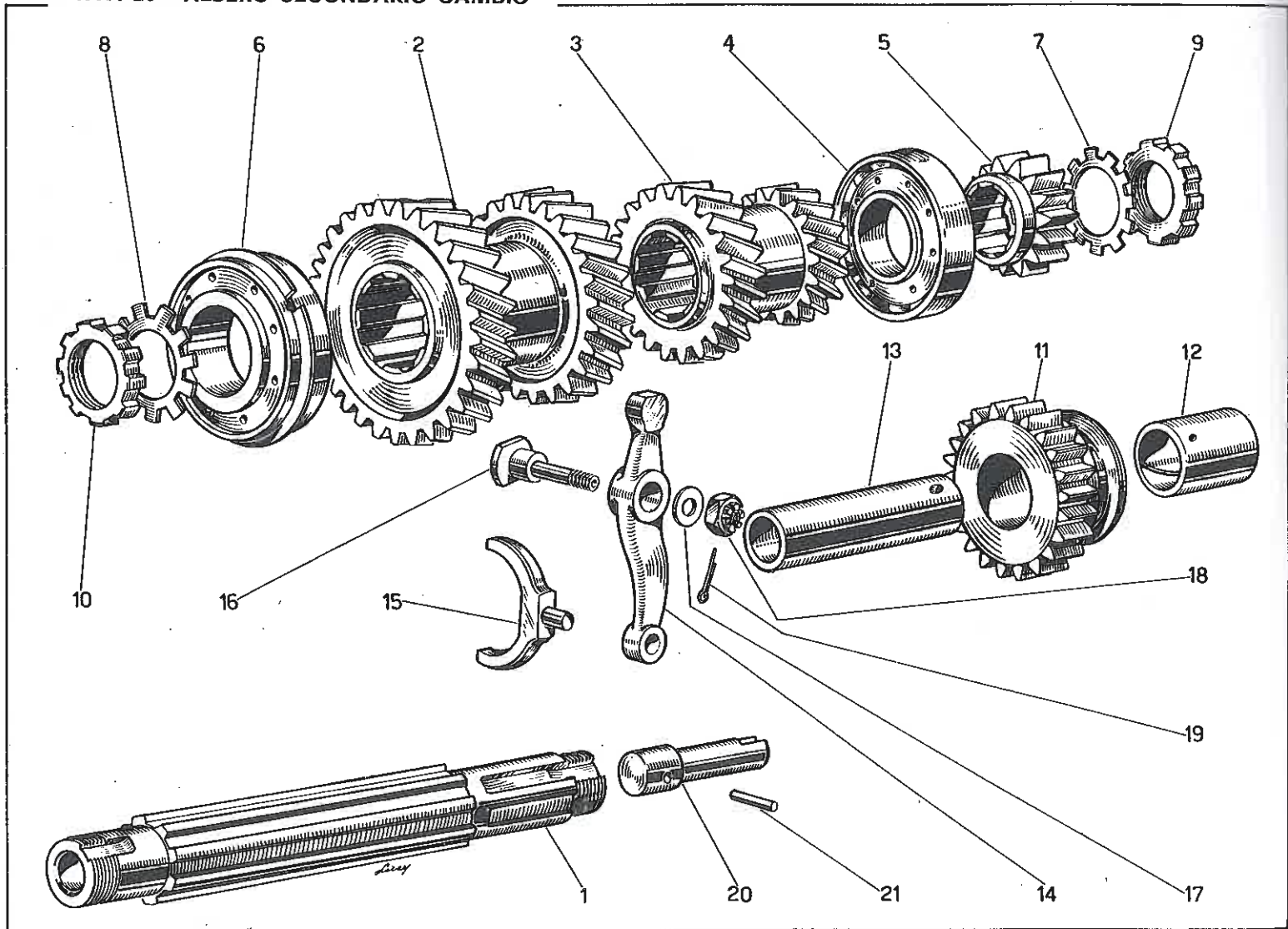

TAV. 21 - ALBERO PRIMARIO CAMBIO

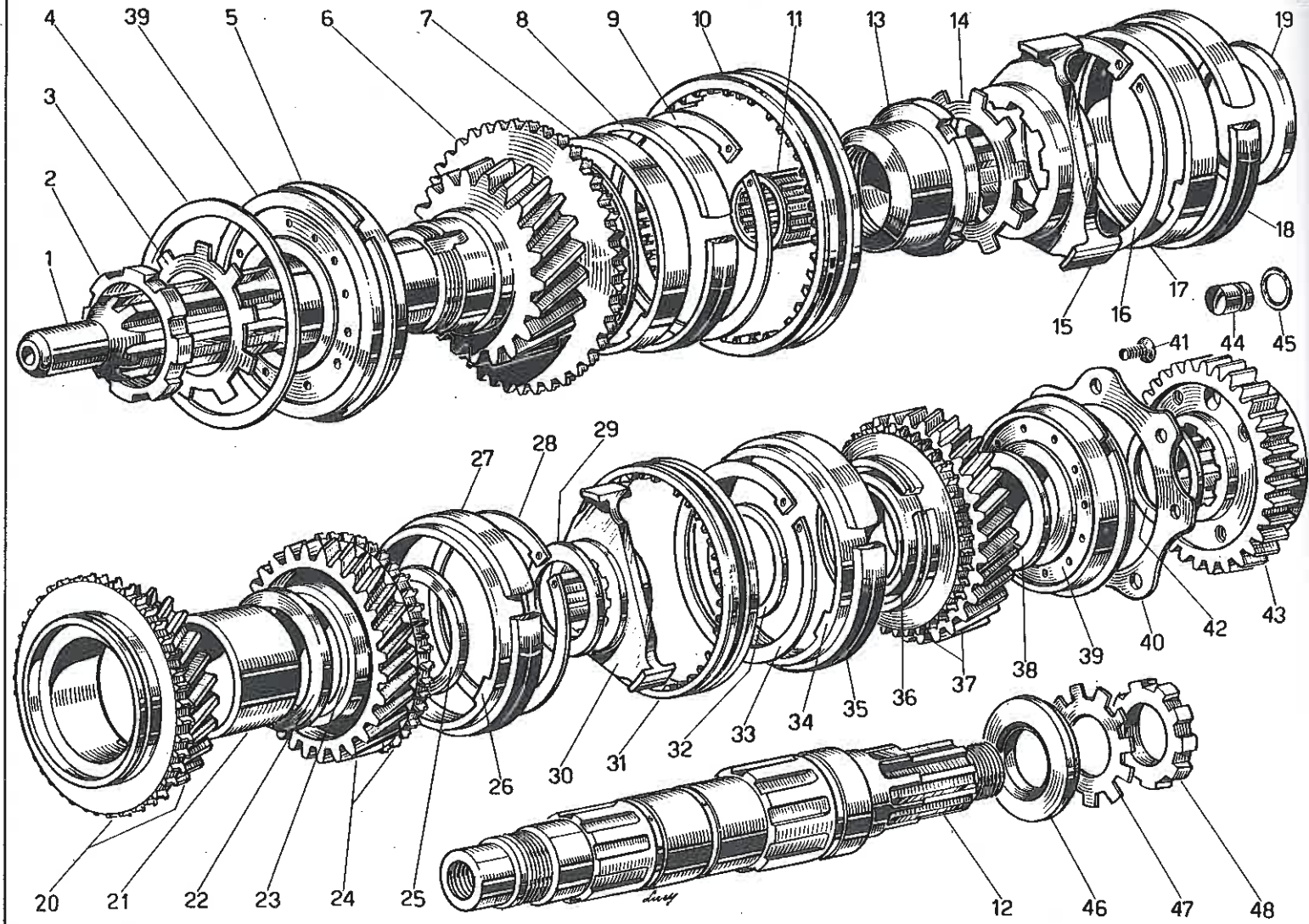

TAV. 23 - ALBERO DI TRASMISSIONE

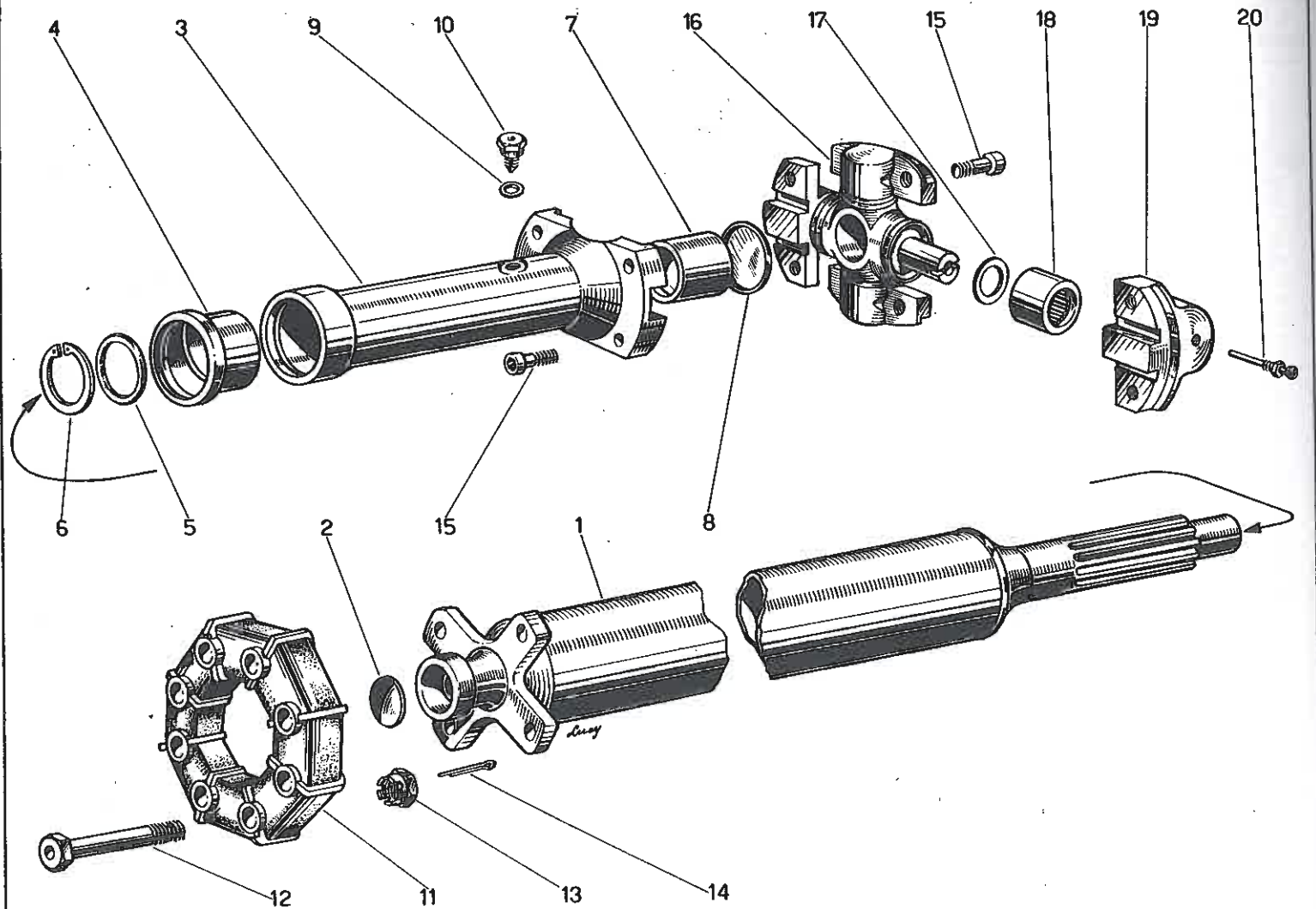

TAV. 24 - GRUPPO DIFFERENZIALE

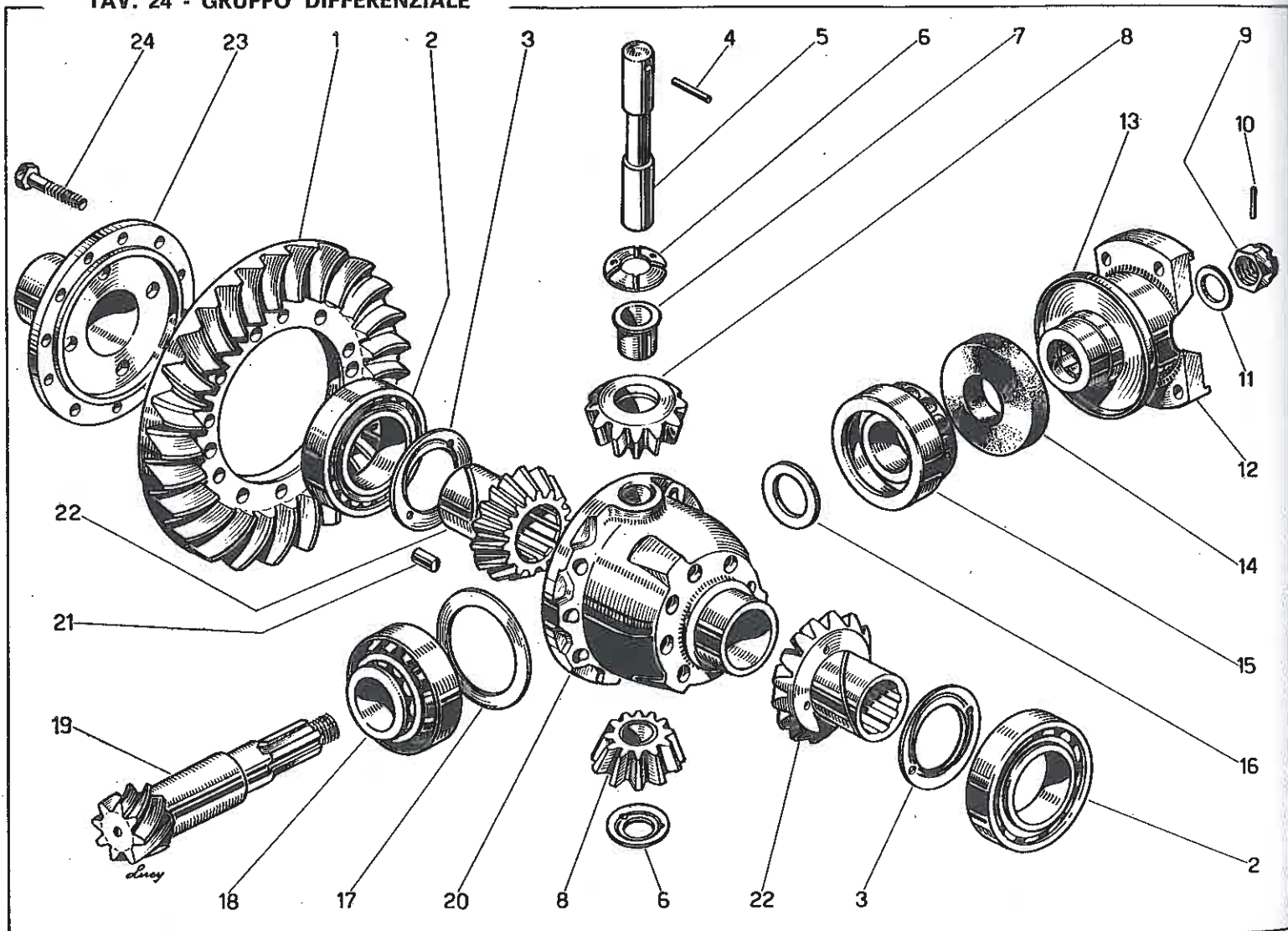

TAV. 25 - PONTE POSTERIORE

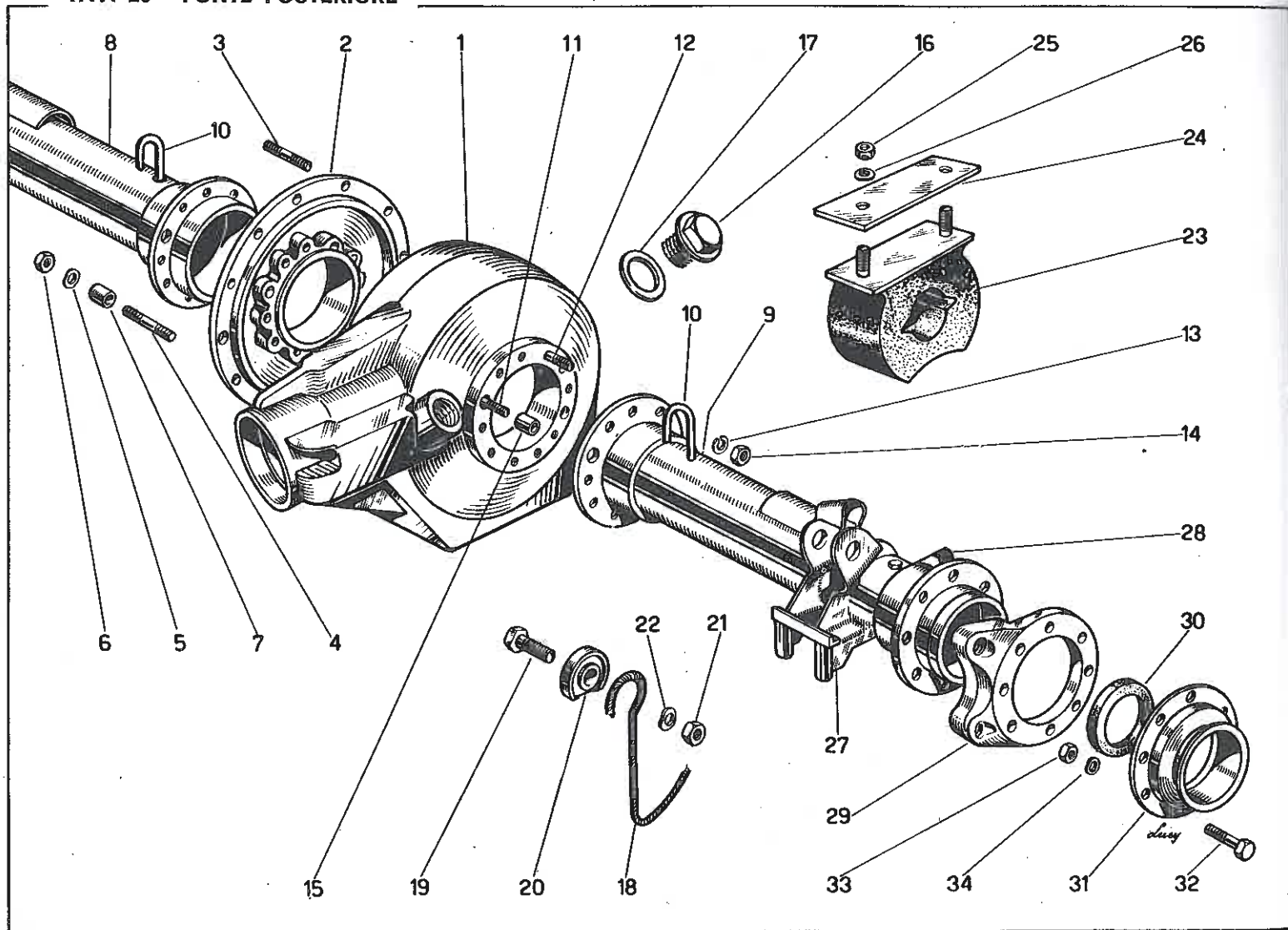

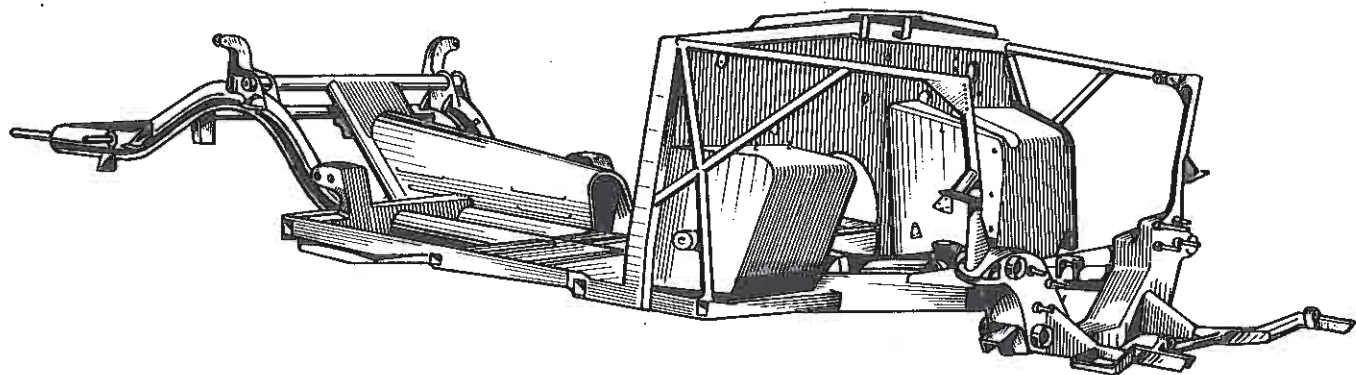

TAV. 28 - SOSPENSIONE ANTERIORE - BRACCI SUPERIORI

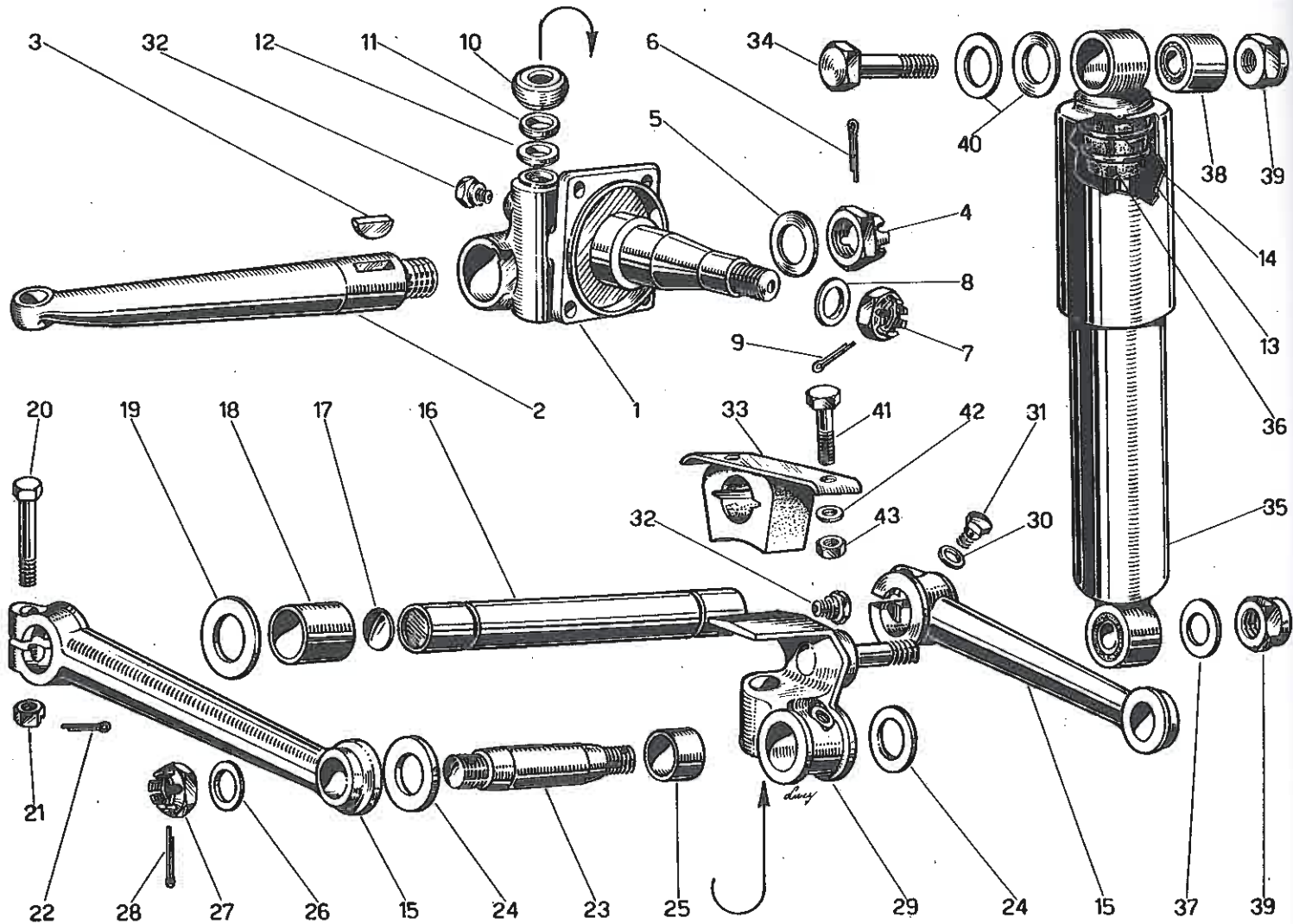

TAV. 29 - SOSPENSIONE ANTERIORE - BRACCI INFERIORI

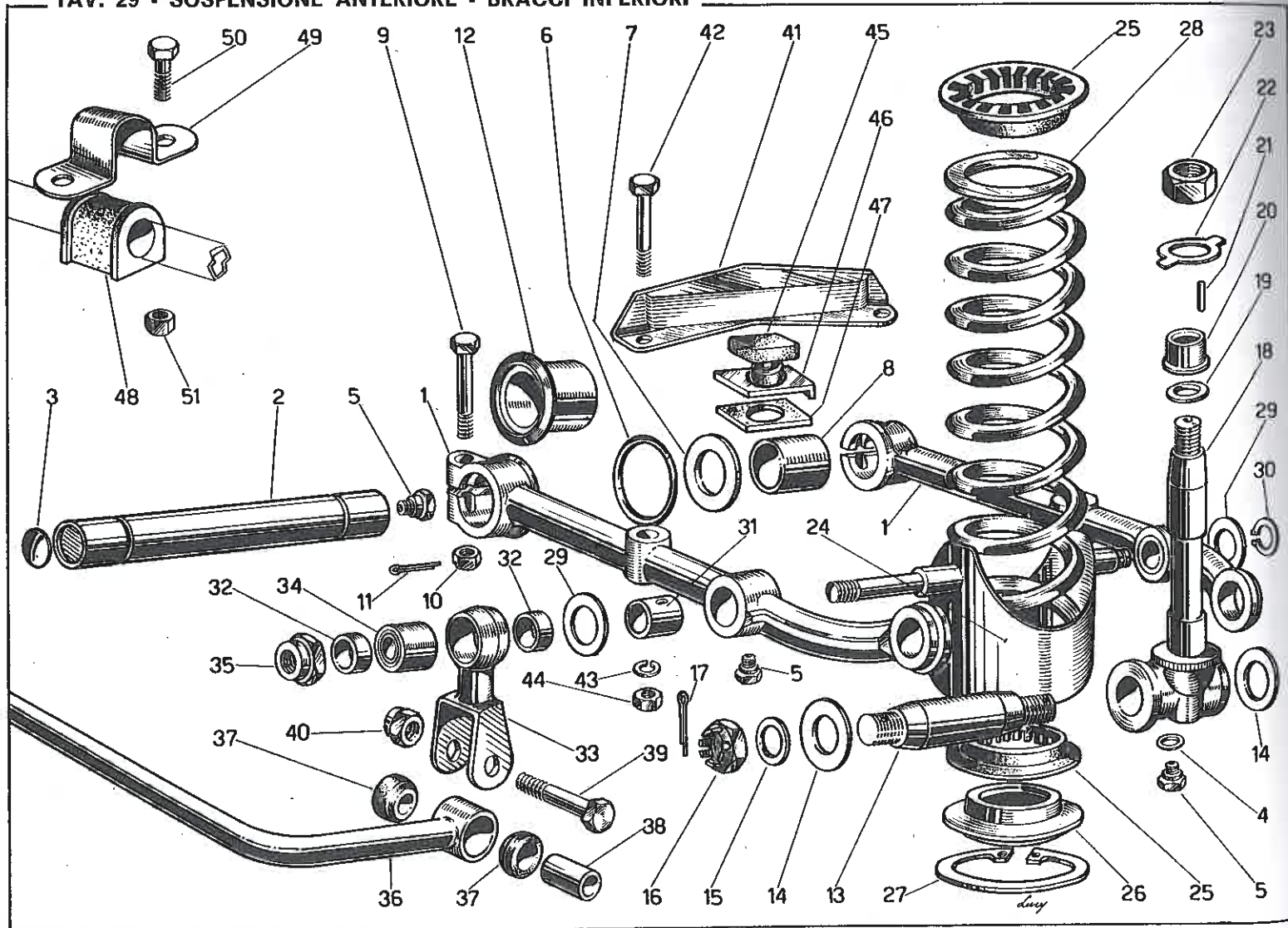

TAV. 30 - PEDALIERA

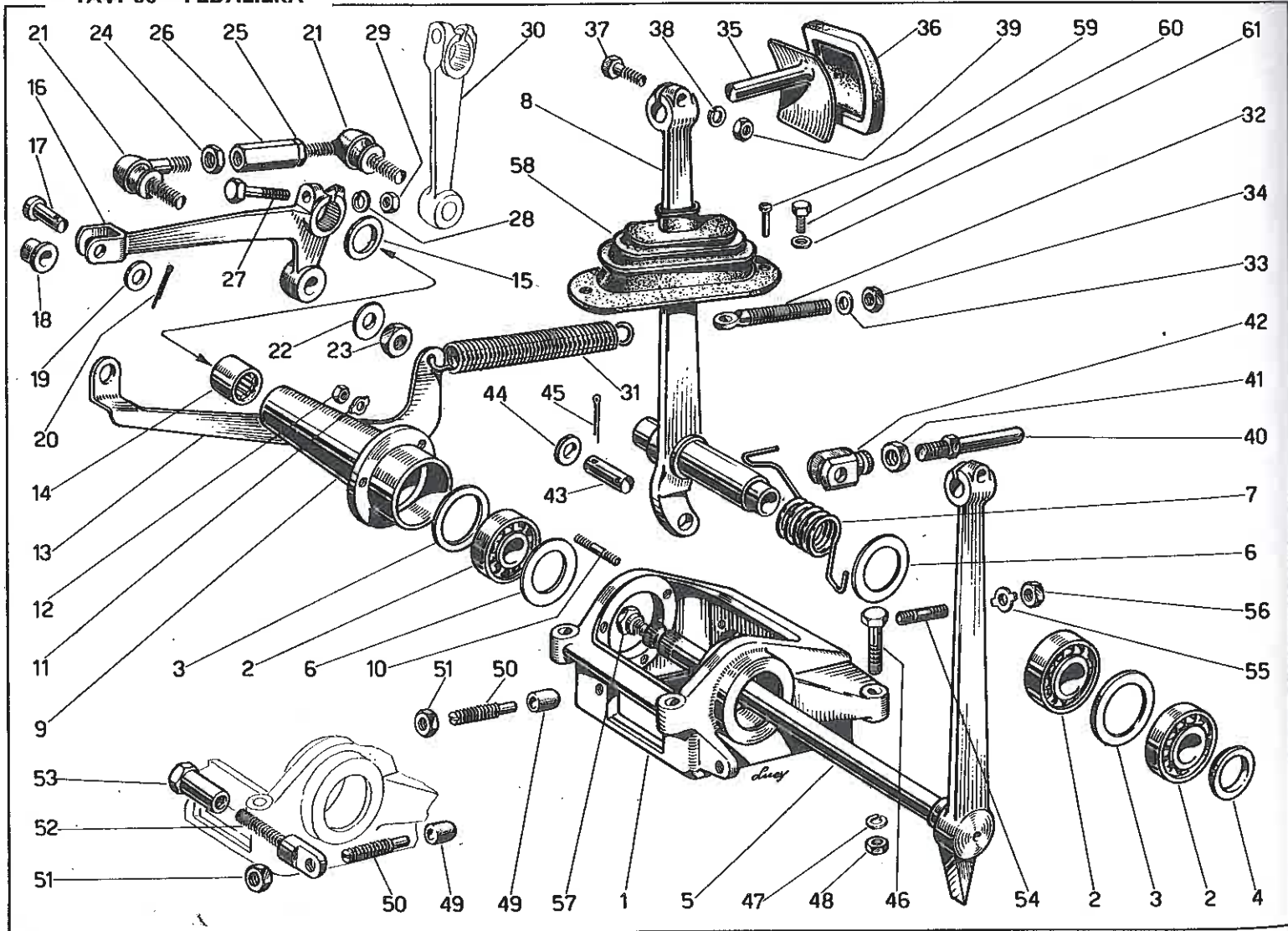

TAV. 31 - COMANDO FRENI

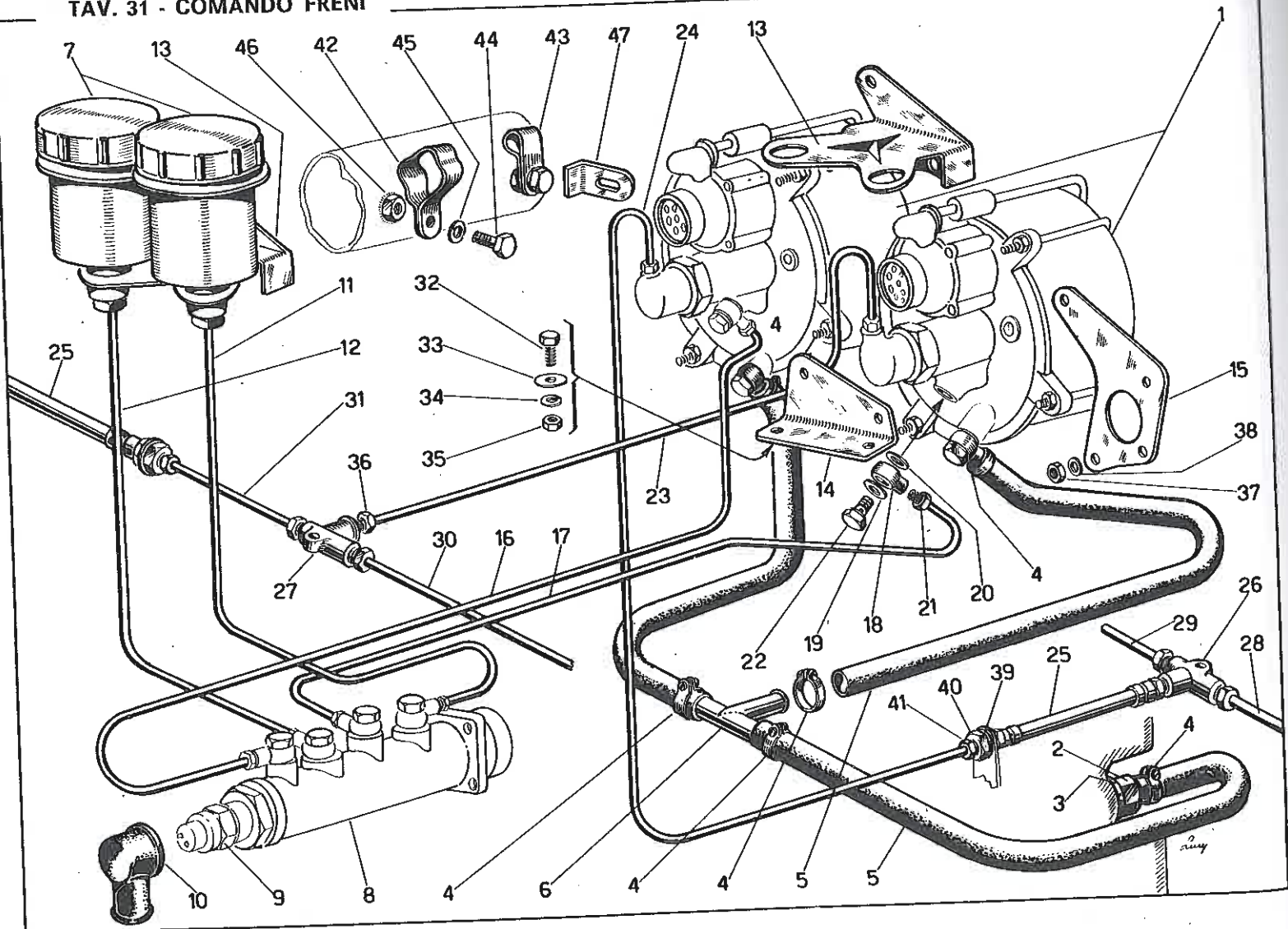

TAV. 32 - POMPA DOPPIA DI COMANDO

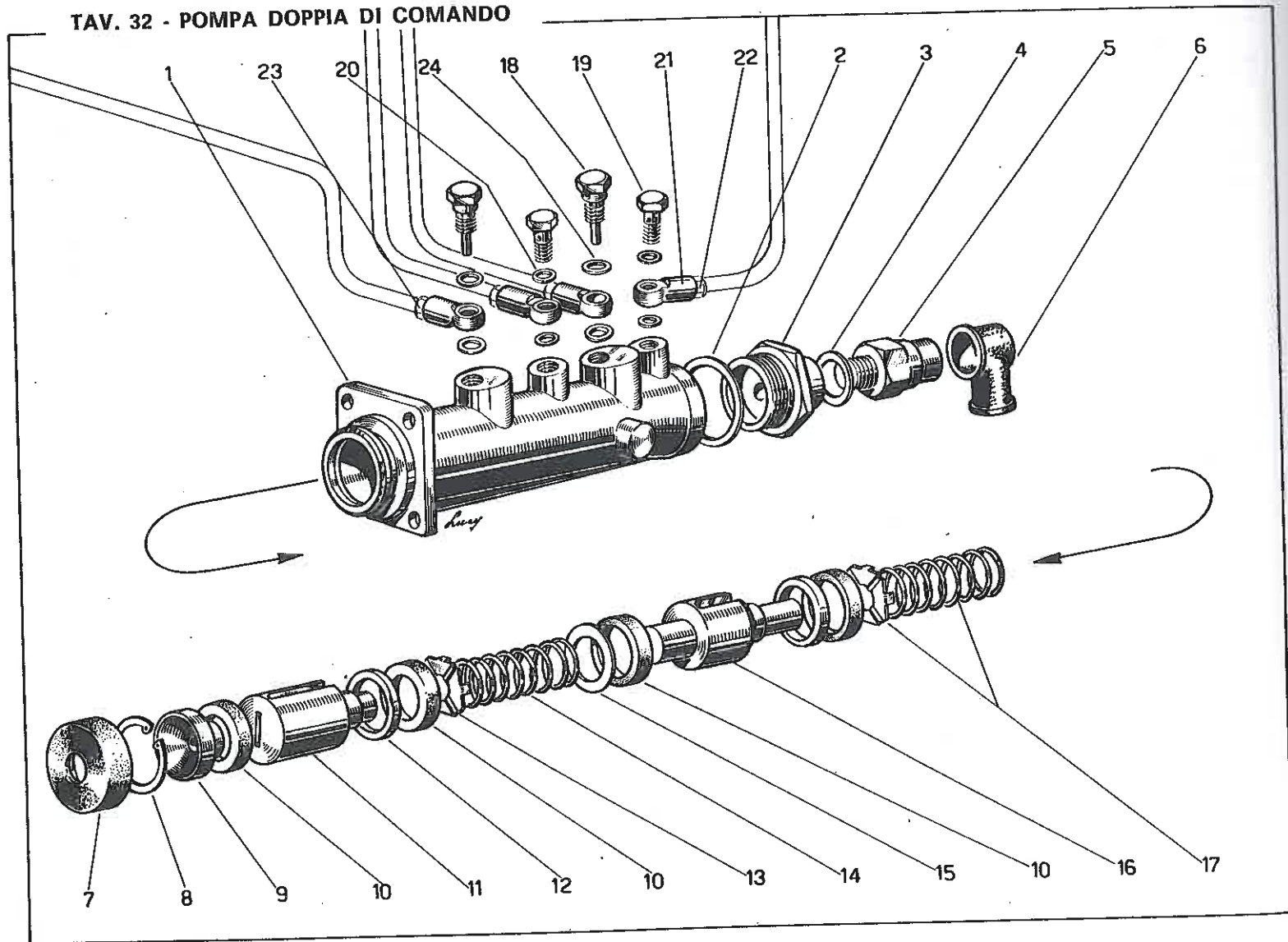

TAV. 33 - FRENO E MOZZI ANTERIORI

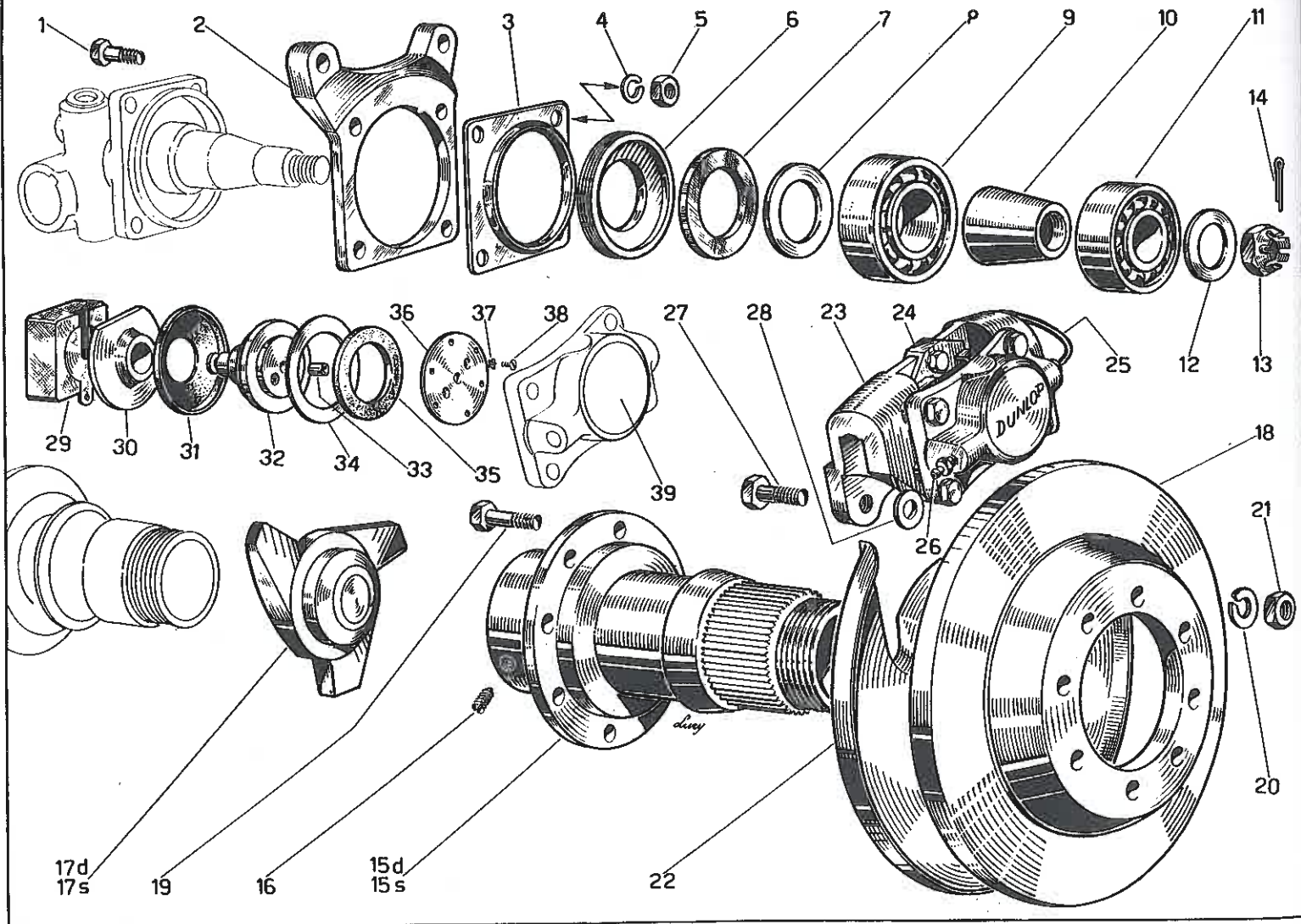

TAV. 35 - GOMME - RUOTE - MOZZI - SEMIASSI

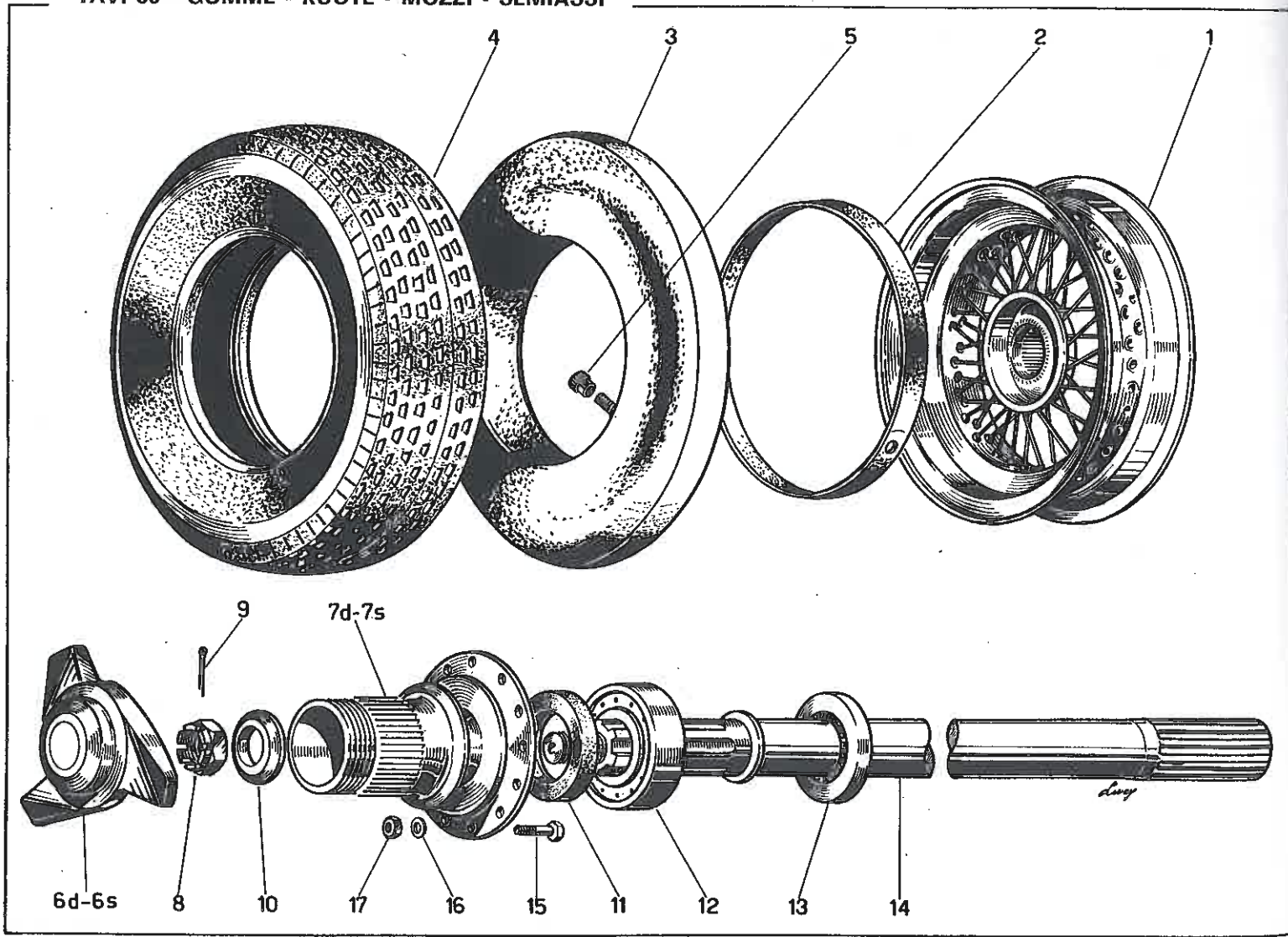

TAV. 36 - SCATOLA GUIDA

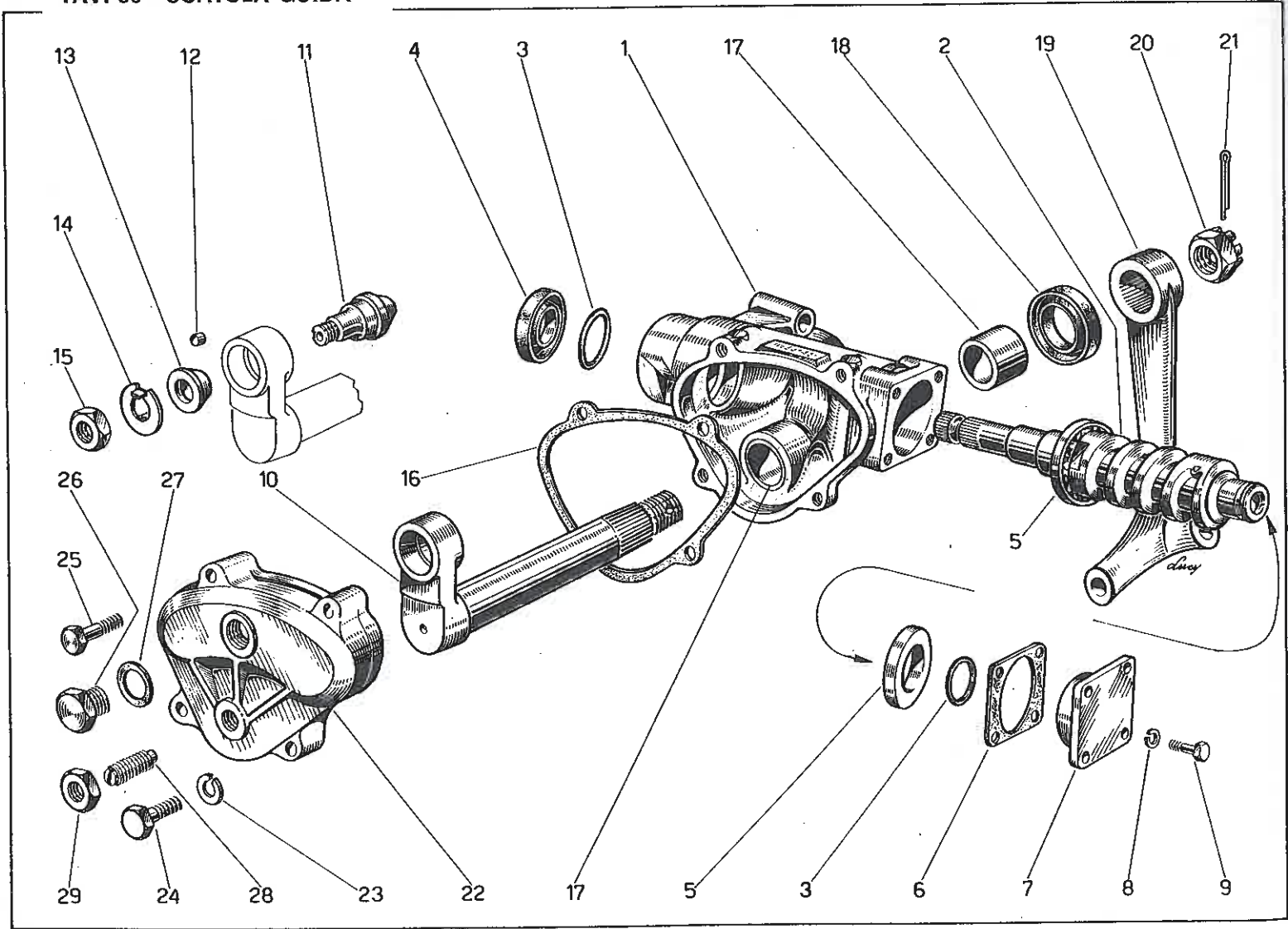

TAV. 38 - ORGANI DI STERZO

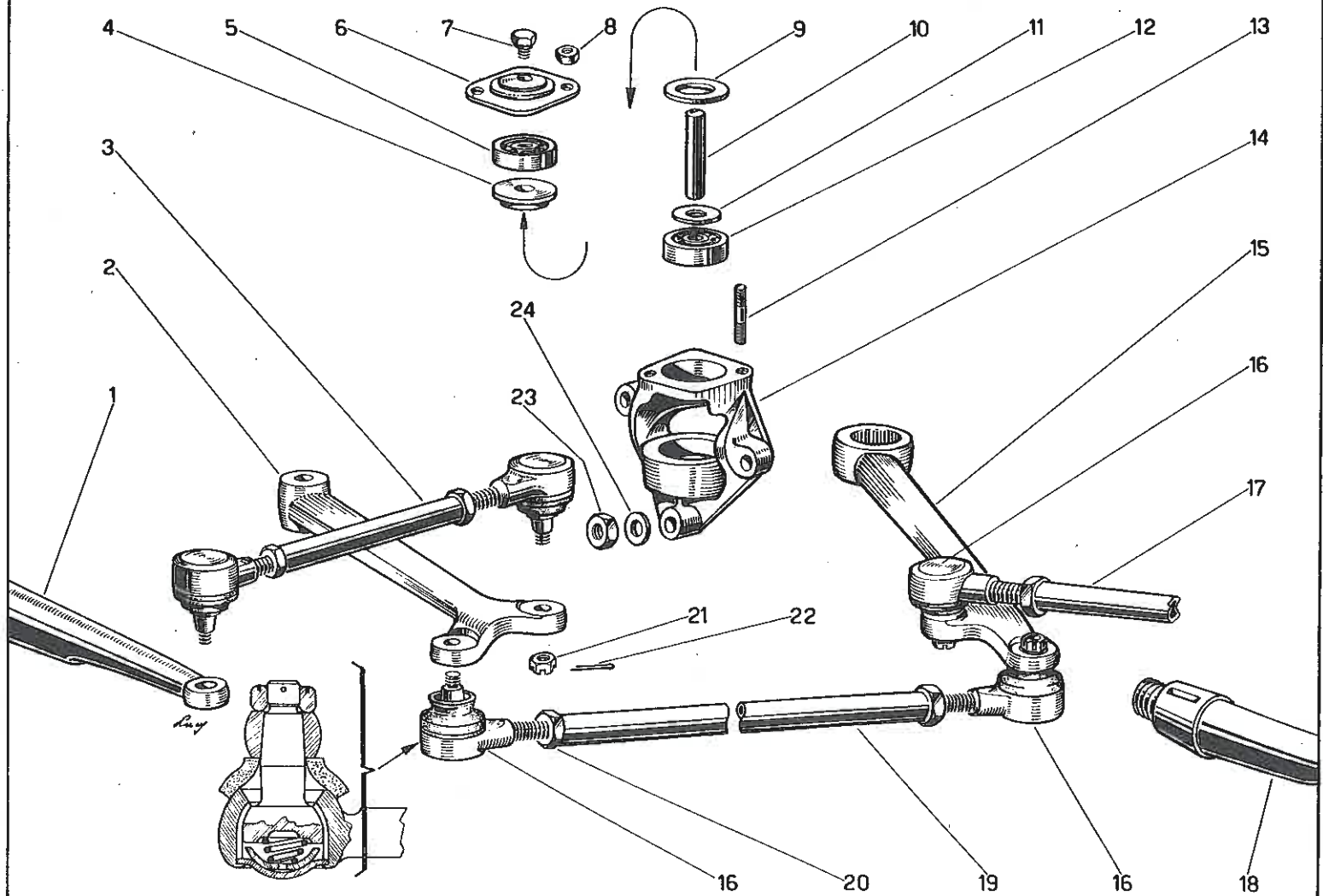

TAV. 39 - RADIATORE ACQUA

